

③ Spiral Pointed Tap Series for through hole

Overall length	Thread length	Thread + Neck length	Shank dia.	Size of square	Length of square
L	ℓ	ℓ _n	D _s	K	ℓ _k

- ANSI
- ① Spiral Fluted Taps (for blind hole)
- ② Spiral Fluted Taps (for through hole)
- ③ Spiral Pointed Taps (for through hole)
- ④ Hand Taps
- ⑤ Cemented Carbide Taps
- ⑥ Roll Taps
- ⑦ Special Thread Taps (Simple inspection tools)
- ⑧ Pipe Taps
- ⑨ Thread Mills (Premium Thread Mills)
- ⑩ Dies
- ⑪ Center Drills (Centering Tools)
- ⑫ Precision Machinery/ Medical Surgical Instruments

ANSI

ZELX SS PO



Spiral Pointed Taps for Stainless Steels

Specification



■ Suitable for stainless steels tending to cause work harden and sticky, as well as chrome steels and molybdenum steels. Through hole use.

Tapping Speed depending on Materials

Low carbon steels 低碳素鋼 ~10 (m/min)	Medium carbon steels 中炭素鋼 ~10 (m/min)	High carbon steels 高炭素鋼 ~10 (m/min)	Alloy steels 合金鋼 ~10 (m/min)	Stainless steels ステンレス鋼 ~10 (m/min)
---	--	--	---------------------------------------	--

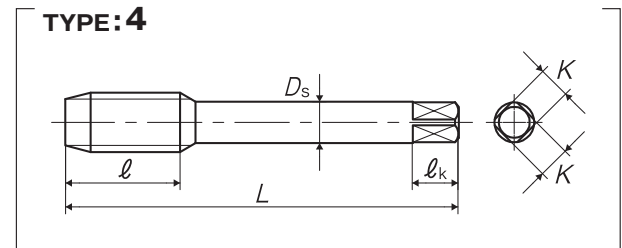
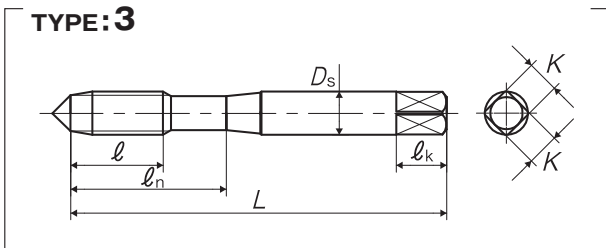
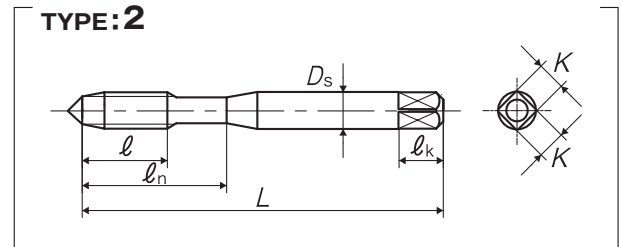
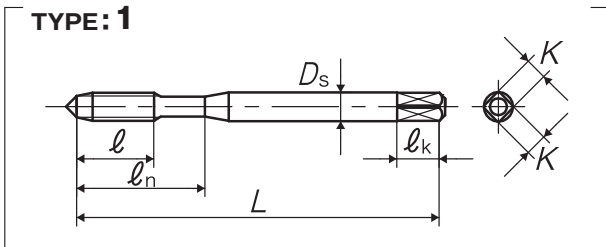

Segment : 1F

Size	Class	Code	Chamfer	L (inch)	ℓ (inch)	ℓ _n (inch)	D _s (inch)	K (inch)	ℓ _k (inch)	No. of flutes	TYPE
For Metric Threads											
M3 × 0.5	D3	Y72615	4.5P	1.937	0.374	0.625	0.141	0.11	0.187	3	1
M3.5 × 0.6	D4	Y72616	4.5P	2	0.413	0.687	0.141	0.11	0.187	3	1
M4 × 0.7	D4	Y72617	4.5P	2.125	0.453	0.75	0.168	0.131	0.25	3	1
M5 × 0.8	D4	Y72619	4.5P	2.375	0.531	0.875	0.194	0.152	0.25	3	1
M6 × 1	D5	Y72620	4.5P	2.5	0.591	1	0.255	0.191	0.312	3	2
M7 × 1	D5	Y72621	4.5P	2.718	0.669	1.125	0.318	0.238	0.375	3	3
M8 × 1.25	D5	Y72623	4.5P	2.718	0.669	1.125	0.318	0.238	0.375	3	3
M8 × 1	D5	Y72622	4.5P	2.718	0.669	1.125	0.318	0.238	0.375	3	3
M10 × 1.5	D6	Y72625	4.5P	2.937	0.748	1.25	0.381	0.286	0.437	3	3
M10 × 1.25	D5	Y72624	4.5P	2.937	0.748	1.25	0.381	0.286	0.437	3	3
M12 × 1.75	D6	Y72627	4.5P	3.375	0.984	-	0.367	0.275	0.437	3	4
M12 × 1.25	D5	Y72626	4.5P	3.375	0.984	-	0.367	0.275	0.437	3	4
M14 × 2	D7	Y72629	4.5P	3.593	0.984	-	0.429	0.322	0.5	3	4
M14 × 1.5	D6	Y72628	4.5P	3.593	0.984	-	0.429	0.322	0.5	3	4
M16 × 2	D7	Y72631	4.5P	3.812	1.083	-	0.48	0.36	0.562	3	4
M16 × 1.5	D6	Y72630	4.5P	3.812	1.083	-	0.48	0.36	0.562	3	4
M18 × 2.5	D7	Y72633	4.5P	4.031	1.083	-	0.542	0.406	0.625	3	4

ANSI



· This product is different from JIS products in shape and dimensions, please be careful when using.

Overall length	Thread length	Thread + Neck length	Shank dia.	Size of square	Length of square
L	ℓ	ℓn	Ds	K	ℓk

Size	Class	Code	Chamfer	L (inch)	ℓ (inch)	ℓn (inch)	Ds (inch)	K (inch)	ℓk (inch)	No. of flutes	TYPE
M18 × 1.5	D6	Y72632	4.5P	4.031	1.083	-	0.542	0.406	0.625	3	4
For Unified Threads											
No.2-56UNC	GH2	Y82623	4.5P	1.75	0.256	0.437	0.141	0.11	0.187	2	1
No.2-56UNC	GH3	Y82624	4.5P	1.75	0.256	0.437	0.141	0.11	0.187	2	1
No.3-48UNC	GH2	Y82600	4.5P	1.812	0.295	0.5	0.141	0.11	0.187	2	1
No.4-40UNC	GH2	Y82601	4.5P	1.875	0.335	0.562	0.141	0.11	0.187	2	1
No.4-40UNC	GH3	Y82602	4.5P	1.875	0.335	0.562	0.141	0.11	0.187	2	1
No.4-40UNC	GH4	Y82612	4.5P	1.875	0.335	0.562	0.141	0.11	0.187	2	1
No.4-40UNC	GH5	Y82634	4.5P	1.875	0.335	0.562	0.141	0.11	0.187	2	1
No.4-48UNF	GH2	Y82683	4.5P	1.875	0.335	0.562	0.141	0.11	0.187	2	1
No.5-40UNC	GH2	Y82603	4.5P	1.937	0.374	0.625	0.141	0.11	0.187	3	1
No.6-32UNC	GH2	Y82604	4.5P	2	0.413	0.687	0.141	0.11	0.187	3	1
No.6-32UNC	GH3	Y82605	4.5P	2	0.413	0.687	0.141	0.11	0.187	3	1
No.6-32UNC	GH4	Y82608	4.5P	2	0.413	0.687	0.141	0.11	0.187	3	1
No.6-32UNC	GH5	Y82635	4.5P	2	0.413	0.687	0.141	0.11	0.187	3	1
No.6-32UNC	GH6	Y82659	4.5P	2	0.413	0.687	0.141	0.11	0.187	3	1
No.6-32UNC	GH7	Y82665	4.5P	2	0.413	0.687	0.141	0.11	0.187	3	1
No.6-40UNF	GH2	Y82684	4.5P	2	0.413	0.687	0.141	0.11	0.187	3	1
No.6-40UNF	GH3	Y82642	4.5P	2	0.413	0.687	0.141	0.11	0.187	3	1
No.8-32UNC	GH2	Y82606	4.5P	2.125	0.453	0.75	0.168	0.131	0.25	3	1
No.8-32UNC	GH3	Y82607	4.5P	2.125	0.453	0.75	0.168	0.131	0.25	3	1
No.8-32UNC	GH4	Y82629	4.5P	2.125	0.453	0.75	0.168	0.131	0.25	3	1
No.8-32UNC	GH5	Y82637	4.5P	2.125	0.453	0.75	0.168	0.131	0.25	3	1
No.8-32UNC	GH6	Y82660	4.5P	2.125	0.453	0.75	0.168	0.131	0.25	3	1
No.8-32UNC	GH7	Y82667	4.5P	2.125	0.453	0.75	0.168	0.131	0.25	3	1
No.8-36UNF	GH2	Y82686	4.5P	2.125	0.453	0.75	0.168	0.131	0.25	3	1
No.10-24UNC	GH3	Y82609	4.5P	2.375	0.531	0.875	0.194	0.152	0.25	3	1
No.10-24UNC	GH5	Y82639	4.5P	2.375	0.531	0.875	0.194	0.152	0.25	3	1
No.10-24UNC	GH6	Y82690	4.5P	2.375	0.531	0.875	0.194	0.152	0.25	3	1
No.10-24UNC	GH7	Y82669	4.5P	2.375	0.531	0.875	0.194	0.152	0.25	3	1
No.10-32UNF	GH2	Y82611	4.5P	2.375	0.531	0.875	0.194	0.152	0.25	3	1
No.10-32UNF	GH3	Y82610	4.5P	2.375	0.531	0.875	0.194	0.152	0.25	3	1
No.10-32UNF	GH4	Y82630	4.5P	2.375	0.531	0.875	0.194	0.152	0.25	3	1
No.10-32UNF	GH5	Y82640	4.5P	2.375	0.531	0.875	0.194	0.152	0.25	3	1
No.10-32UNF	GH6	Y82661	4.5P	2.375	0.531	0.875	0.194	0.152	0.25	3	1
No.10-32UNF	GH7	Y82670	4.5P	2.375	0.531	0.875	0.194	0.152	0.25	3	1
No.12-24UNC	GH3	Y82688	4.5P	2.375	0.571	0.937	0.22	0.165	0.281	3	1
No.12-28UNF	GH3	Y82689	4.5P	2.375	0.571	0.937	0.22	0.165	0.281	3	1
1/4-20UNC	GH3	Y82613	4.5P	2.5	0.591	1	0.255	0.191	0.312	3	2
1/4-20UNC	GH5	Y82643	4.5P	2.5	0.591	1	0.255	0.191	0.312	3	2
1/4-20UNC	GH6	Y82590	4.5P	2.5	0.591	1	0.255	0.191	0.312	3	2
1/4-20UNC	GH7	Y82673	4.5P	2.5	0.591	1	0.255	0.191	0.312	3	2
1/4-28UNF	GH3	Y82614	4.5P	2.5	0.591	1	0.255	0.191	0.312	3	2
1/4-28UNF	GH4	Y82631	4.5P	2.5	0.591	1	0.255	0.191	0.312	3	2
1/4-28UNF	GH5	Y82644	4.5P	2.5	0.591	1	0.255	0.191	0.312	3	2
1/4-28UNF	GH6	Y82662	4.5P	2.5	0.591	1	0.255	0.191	0.312	3	2
1/4-28UNF	GH7	Y82674	4.5P	2.5	0.591	1	0.255	0.191	0.312	3	2
5/16-18UNC	GH3	Y82615	4.5P	2.718	0.669	1.125	0.318	0.238	0.375	3	3
5/16-18UNC	GH5	Y82645	4.5P	2.718	0.669	1.125	0.318	0.238	0.375	3	3
5/16-18UNC	GH7	Y82675	4.5P	2.718	0.669	1.125	0.318	0.238	0.375	3	3

· This product is different from JIS products in shape and dimensions, please be careful when using.

3 Spiral Pointed Tap Series for through hole

Overall length	Thread length	Thread + Neck length	Shank dia.	Size of square	Length of square
L	ℓ	ℓn	Ds	K	ℓk

- ① Spiral Fluted Taps (for blind hole)
- ② Spiral Fluted Taps (for through hole)
- ③ Spiral Pointed Taps (for through hole)
- ④ Hand Taps
- ⑤ Cemented Carbide Taps
- ⑥ Roll Taps
- ⑦ Special Thread Taps (Simple inspection tools)
- ⑧ Pipe Taps
- ⑨ Thread Mills (Premium Thread Mills)
- ⑩ Dies
- ⑪ Center Drills (Centering Tools)
- ⑫ Precision Machinery/ Medical Surgical Instruments

ZELX SS PO Spiral Pointed Taps for Stainless Steels

Size	Class	Code	Chamfer	L (inch)	ℓ (inch)	ℓn (inch)	Ds (inch)	K (inch)	ℓk (inch)	No. of flutes	TYPE
5/16-24UNF	GH3	Y82616	4.5P	2.718	0.669	1.125	0.318	0.238	0.375	3	3
5/16-24UNF	GH4	Y82632	4.5P	2.718	0.669	1.125	0.318	0.238	0.375	3	3
5/16-24UNF	GH5	Y82646	4.5P	2.718	0.669	1.125	0.318	0.238	0.375	3	3
5/16-24UNF	GH6	Y82663	4.5P	2.718	0.669	1.125	0.318	0.238	0.375	3	3
5/16-24UNF	GH7	Y82676	4.5P	2.718	0.669	1.125	0.318	0.238	0.375	3	3
3/8-16UNC	GH3	Y82617	4.5P	2.937	0.748	1.25	0.381	0.286	0.437	3	3
3/8-16UNC	GH5	Y82647	4.5P	2.937	0.748	1.25	0.381	0.286	0.437	3	3
3/8-16UNC	GH7	Y82668	4.5P	2.937	0.748	1.25	0.381	0.286	0.437	3	3
3/8-24UNF	GH3	Y82618	4.5P	2.937	0.748	1.25	0.381	0.286	0.437	3	3
3/8-24UNF	GH4	Y82633	4.5P	2.937	0.748	1.25	0.381	0.286	0.437	3	3
3/8-24UNF	GH5	Y82648	4.5P	2.937	0.748	1.25	0.381	0.286	0.437	3	3
3/8-24UNF	GH6	Y82664	4.5P	2.937	0.748	1.25	0.381	0.286	0.437	3	3
3/8-24UNF	GH7	Y82678	4.5P	2.937	0.748	1.25	0.381	0.286	0.437	3	3
7/16-14UNC	GH3	Y82619	4.5P	3.156	0.866	-	0.323	0.242	0.406	3	4
7/16-14UNC	GH5	Y82649	4.5P	3.156	0.866	-	0.323	0.242	0.406	3	4
7/16-20UNF	GH3	Y82620	4.5P	3.156	0.866	-	0.323	0.242	0.406	3	4
7/16-20UNF	GH5	Y82650	4.5P	3.156	0.866	-	0.323	0.242	0.406	3	4
7/16-20UNF	GH6	Y82691	4.5P	3.156	0.866	-	0.323	0.242	0.406	3	4
7/16-20UNF	GH7	Y82680	4.5P	3.156	0.866	-	0.323	0.242	0.406	3	4
1/2-13UNC	GH3	Y82621	4.5P	3.375	0.984	-	0.367	0.275	0.437	3	4
1/2-13UNC	GH5	Y82651	4.5P	3.375	0.984	-	0.367	0.275	0.437	3	4
1/2-13UNC	GH7	Y82681	4.5P	3.375	0.984	-	0.367	0.275	0.437	3	4
1/2-20UNF	GH3	Y82622	4.5P	3.375	0.984	-	0.367	0.275	0.437	3	4
1/2-20UNF	GH5	Y82652	4.5P	3.375	0.984	-	0.367	0.275	0.437	3	4
1/2-20UNF	GH6	Y82692	4.5P	3.375	0.984	-	0.367	0.275	0.437	3	4
1/2-20UNF	GH7	Y82682	4.5P	3.375	0.984	-	0.367	0.275	0.437	3	4
1/2-20UNF	GH9	Y82685	4.5P	3.375	0.984	-	0.367	0.275	0.437	3	4
9/16-12UNC	GH3	Y82653	4.5P	3.593	0.984	-	0.429	0.322	0.5	3	4
9/16-18UNF	GH3	Y82654	4.5P	3.593	0.984	-	0.429	0.322	0.5	3	4
9/16-18UNF	GH5	Y82666	4.5P	3.593	0.984	-	0.429	0.322	0.5	3	4
5/8-11UNC	GH3	Y82625	4.5P	3.812	1.083	-	0.48	0.36	0.562	3	4
5/8-11UNC	GH5	Y82655	4.5P	3.812	1.083	-	0.48	0.36	0.562	3	4
5/8-18UNF	GH3	Y82626	4.5P	3.812	1.083	-	0.48	0.36	0.562	3	4
5/8-18UNF	GH4	Y82636	4.5P	3.812	1.083	-	0.48	0.36	0.562	3	4
5/8-18UNF	GH5	Y82656	4.5P	3.812	1.083	-	0.48	0.36	0.562	3	4
5/8-18UNF	GH6	Y82694	4.5P	3.812	1.083	-	0.48	0.36	0.562	3	4
5/8-18UNF	GH7	Y82591	4.5P	3.812	1.083	-	0.48	0.36	0.562	3	4
3/4-10UNC	GH3	Y82627	4.5P	4.25	1.201	-	0.59	0.422	0.687	3	4
3/4-10UNC	GH5	Y82657	4.5P	4.25	1.201	-	0.59	0.422	0.687	3	4
3/4-16UNF	GH3	Y82628	4.5P	4.25	1.201	-	0.59	0.422	0.687	3	4
3/4-16UNF	GH5	Y82658	4.5P	4.25	1.201	-	0.59	0.422	0.687	3	4
3/4-16UNF	GH7	Y82592	4.5P	4.25	1.201	-	0.59	0.422	0.687	3	4
7/8-9UNC	GH4	Y82695	4.5P	4.687	1.339	-	0.697	0.523	0.75	3	4
7/8-14UNF	GH4	Y82696	4.5P	4.687	1.339	-	0.697	0.523	0.75	3	4
7/8-14UNF	GH6	Y82699	4.5P	4.687	1.339	-	0.697	0.523	0.75	3	4
1 -8UNC	GH4	Y82697	4.5P	5.125	1.496	-	0.8	0.6	0.812	3	4
1 -12UNF	GH4	Y82679	4.5P	5.125	1.496	-	0.8	0.6	0.812	3	4
1 1/8-7UNC	GH6	Y82700	4.5P	5.437	1.535	-	0.896	0.672	0.875	4	4
1 1/8-12UNF	GH5	Y82701	4.5P	5.437	1.535	-	0.896	0.672	0.875	4	4
1 1/4-7UNC	GH6	Y82702	4.5P	5.75	1.535	-	1.021	0.766	1	4	4

This product is different from JIS products in shape and dimensions, please be careful when using.

Overall length	Thread length	Thread + Neck length	Shank dia.	Size of square	Length of square
L	ℓ	ℓn	Ds	K	ℓk

3

ANSI

ZELX SS PO Spiral Pointed Taps for Stainless Steels

Size	Class	Code	Chamfer	L (inch)	ℓ (inch)	ℓn (inch)	Ds (inch)	K (inch)	ℓk (inch)	No. of flutes	TYPE
1 1/4-12UNF	GH5	Y82703	4.5P	5.75	1.535	-	1.021	0.766	1	4	4
1 3/8-6UNC	GH6	Y82705	4.5P	6.062	1.811	-	1.108	0.831	1.062	4	4
1 3/8-12UNF	GH5	Y82706	4.5P	6.062	1.811	-	1.108	0.831	1.062	4	4
1 1/2-6UNC	GH6	Y82707	4.5P	6.375	1.811	-	1.233	0.925	1.125	4	4
1 1/2-12UNF	GH5	Y82708	4.5P	6.375	1.811	-	1.233	0.925	1.125	4	4
1 3/4-5UNC	GH7	Y82709	4.5P	7	1.929	-	1.43	1.072	1.25	4	4
2 -4 1/2UNC	GH7	Y82710	4.5P	7.625	1.929	-	1.644	1.233	1.375	4	4

Spiral Fluted Taps
(for blind hole)

①

Spiral Fluted Taps
(for through hole)

②

Spiral Pointed Taps
(for through hole)

③

Hand Taps

④

Cemented Carbide Taps

⑤

Roll Taps

⑥

Special Thread Taps
Simple Inspection Tools

⑦

Pipe Taps

⑧

Thread Mills
Premium Thread Mills

⑨

Dies

⑩

Center Drills
Centering Tools

⑪

Precision Machinery/
Metal Surgical Instruments

⑫

ANSI

③-70