

③ Spiral Pointed Tap Series for through hole

Overall length	Thread length	Thread + Neck length	Shank dia.	Size of square	Length of square
L	ℓ	ℓn	Ds	K	ℓk



ZELX NI PO

Spiral Pointed Taps for Nickel Base Alloys

Specification



ZELX NI PO is the spiral pointed tap for nickel base alloys which, with nickel as main composition, have much higher corrosion resistance and much higher heat resistance than steels.

Tapping Speed depending on Materials

Low carbon steels 低炭素鋼	Medium carbon steels 中炭素鋼	Stainless steels ステンレス鋼	Nickel base alloys ニッケル基合金
5~10 (m/min)	5~10 (m/min)	5~10 (m/min)	5~10 (m/min)

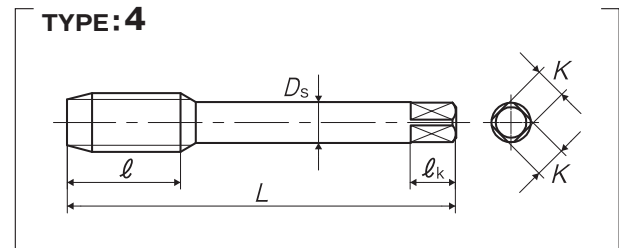
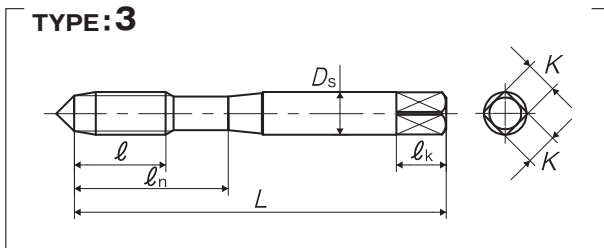
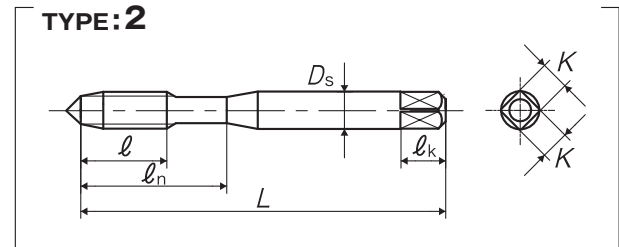
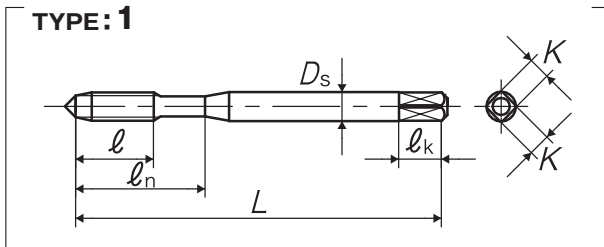

Segment : 1F

Size	Class	Code	Chamfer	L (inch)	ℓ (inch)	ℓn (inch)	Ds (inch)	K (inch)	ℓk (inch)	No. of flutes	TYPE
For Metric Threads											
M2.5 × 0.45	D3	Y87320	4.5P	1.812	0.295	0.5	0.141	0.11	0.187	2	1
M3 × 0.5	D3	Y87321	4.5P	1.937	0.374	0.625	0.141	0.11	0.187	3	1
M3.5 × 0.6	D4	Y87322	4.5P	2	0.413	0.687	0.141	0.11	0.187	3	1
M4 × 0.7	D4	Y87323	4.5P	2.125	0.453	0.75	0.168	0.131	0.25	3	1
M5 × 0.8	D4	Y87324	4.5P	2.375	0.531	0.875	0.194	0.152	0.25	3	1
M6 × 1	D5	Y87325	4.5P	2.5	0.591	1	0.255	0.191	0.312	3	2
M7 × 1	D5	Y87326	4.5P	2.718	0.669	1.125	0.318	0.238	0.375	3	3
M8 × 1.25	D5	Y87328	4.5P	2.718	0.669	1.125	0.318	0.238	0.375	3	3
M8 × 1	D5	Y87327	4.5P	2.718	0.669	1.125	0.318	0.238	0.375	3	3
M10 × 1.5	D6	Y87330	4.5P	2.937	0.748	1.25	0.381	0.286	0.437	3	3
M10 × 1.25	D5	Y87329	4.5P	2.937	0.748	1.25	0.381	0.286	0.437	3	3
M12 × 1.75	D6	Y87332	4.5P	3.375	0.984	-	0.367	0.275	0.437	3	4
M12 × 1.25	D5	Y87331	4.5P	3.375	0.984	-	0.367	0.275	0.437	3	4
For Unified Threads											
No.2-56UNC	GH2	Y85523	4.5P	1.75	0.256	0.437	0.141	0.11	0.187	2	1
No.4-40UNC	GH2	Y85501	4.5P	1.875	0.335	0.562	0.141	0.11	0.187	2	1
No.4-40UNC	GH3	Y85502	4.5P	1.875	0.335	0.562	0.141	0.11	0.187	2	1



This product is different from JIS products in shape and dimensions, please be careful when using.

- ① Spiral Fluted Taps (for blind hole)
- ② Spiral Fluted Taps (for through hole)
- ③ Spiral Pointed Taps (for through hole)
- ④ Hand Taps
- ⑤ Cemented Carbide Taps
- ⑥ Roll Taps
- ⑦ Special Thread Taps (Simple inspection tools)
- ⑧ Pipe Taps
- ⑨ Thread Mills (Premium Thread Mills)
- ⑩ Dies
- ⑪ Center Drills (Centering Tools)
- ⑫ Precision Machinery/ Medical Surgical Instruments

Overall length	Thread length	Thread + Neck length	Shank dia.	Size of square	Length of square
L	ℓ	ℓn	Ds	K	ℓk

Size	Class	Code	Chamfer	L (inch)	ℓ (inch)	ℓn (inch)	Ds (inch)	K (inch)	ℓk (inch)	No. of flutes	TYPE
No.4-40UNC	GH4	Y85504	4.5P	1.875	0.335	0.562	0.141	0.11	0.187	2	1
No.5-40UNC	GH2	Y85503	4.5P	1.937	0.374	0.625	0.141	0.11	0.187	3	1
No.6-32UNC	GH3	Y85505	4.5P	2	0.413	0.687	0.141	0.11	0.187	3	1
No.6-32UNC	GH4	Y85524	4.5P	2	0.413	0.687	0.141	0.11	0.187	3	1
No.6-32UNC	GH5	Y85535	4.5P	2	0.413	0.687	0.141	0.11	0.187	3	1
No.6-32UNC	GH7	Y85511	4.5P	2	0.413	0.687	0.141	0.11	0.187	3	1
No.6-40UNF	GH2	Y85512	4.5P	2	0.413	0.687	0.141	0.11	0.187	3	1
No.8-32UNC	GH3	Y85507	4.5P	2.125	0.453	0.75	0.168	0.131	0.25	3	1
No.8-32UNC	GH4	Y85529	4.5P	2.125	0.453	0.75	0.168	0.131	0.25	3	1
No.8-32UNC	GH5	Y85537	4.5P	2.125	0.453	0.75	0.168	0.131	0.25	3	1
No.8-32UNC	GH6	Y85560	4.5P	2.125	0.453	0.75	0.168	0.131	0.25	3	1
No.8-32UNC	GH7	Y85567	4.5P	2.125	0.453	0.75	0.168	0.131	0.25	3	1
No.10-24UNC	GH3	Y85509	4.5P	2.375	0.531	0.875	0.194	0.152	0.25	3	1
No.10-24UNC	GH5	Y85539	4.5P	2.375	0.531	0.875	0.194	0.152	0.25	3	1
No.10-32UNF	GH2	Y85541	4.5P	2.375	0.531	0.875	0.194	0.152	0.25	3	1
No.10-32UNF	GH3	Y85510	4.5P	2.375	0.531	0.875	0.194	0.152	0.25	3	1
No.10-32UNF	GH4	Y85530	4.5P	2.375	0.531	0.875	0.194	0.152	0.25	3	1
No.10-32UNF	GH5	Y85540	4.5P	2.375	0.531	0.875	0.194	0.152	0.25	3	1
No.10-32UNF	GH6	Y85561	4.5P	2.375	0.531	0.875	0.194	0.152	0.25	3	1
No.10-32UNF	GH7	Y85570	4.5P	2.375	0.531	0.875	0.194	0.152	0.25	3	1
1/4-20UNC	GH3	Y85513	4.5P	2.5	0.591	1	0.255	0.191	0.312	3	2
1/4-20UNC	GH5	Y85543	4.5P	2.5	0.591	1	0.255	0.191	0.312	3	2
1/4-28UNF	GH3	Y85514	4.5P	2.5	0.591	1	0.255	0.191	0.312	3	2
1/4-28UNF	GH4	Y85531	4.5P	2.5	0.591	1	0.255	0.191	0.312	3	2
1/4-28UNF	GH5	Y85544	4.5P	2.5	0.591	1	0.255	0.191	0.312	3	2
1/4-28UNF	GH6	Y85562	4.5P	2.5	0.591	1	0.255	0.191	0.312	3	2
1/4-28UNF	GH7	Y85574	4.5P	2.5	0.591	1	0.255	0.191	0.312	3	2
5/16-18UNC	GH3	Y85515	4.5P	2.718	0.669	1.125	0.318	0.238	0.375	3	3
5/16-18UNC	GH5	Y85545	4.5P	2.718	0.669	1.125	0.318	0.238	0.375	3	3
5/16-18UNC	GH7	Y85553	4.5P	2.718	0.669	1.125	0.318	0.238	0.375	3	3
5/16-24UNF	GH3	Y85516	4.5P	2.718	0.669	1.125	0.318	0.238	0.375	3	3
5/16-24UNF	GH4	Y85532	4.5P	2.718	0.669	1.125	0.318	0.238	0.375	3	3
5/16-24UNF	GH5	Y85546	4.5P	2.718	0.669	1.125	0.318	0.238	0.375	3	3
5/16-24UNF	GH6	Y85563	4.5P	2.718	0.669	1.125	0.318	0.238	0.375	3	3
5/16-24UNF	GH7	Y85576	4.5P	2.718	0.669	1.125	0.318	0.238	0.375	3	3
3/8-16UNC	GH3	Y85517	4.5P	2.937	0.748	1.25	0.381	0.286	0.437	3	3
3/8-16UNC	GH5	Y85547	4.5P	2.937	0.748	1.25	0.381	0.286	0.437	3	3
3/8-24UNF	GH3	Y85518	4.5P	2.937	0.748	1.25	0.381	0.286	0.437	3	3
3/8-24UNF	GH4	Y85533	4.5P	2.937	0.748	1.25	0.381	0.286	0.437	3	3
3/8-24UNF	GH5	Y85548	4.5P	2.937	0.748	1.25	0.381	0.286	0.437	3	3
3/8-24UNF	GH6	Y85564	4.5P	2.937	0.748	1.25	0.381	0.286	0.437	3	3
3/8-24UNF	GH7	Y85578	4.5P	2.937	0.748	1.25	0.381	0.286	0.437	3	3
7/16-14UNC	GH3	Y85519	4.5P	3.156	0.866	-	0.323	0.242	0.406	3	4
7/16-14UNC	GH5	Y85549	4.5P	3.156	0.866	-	0.323	0.242	0.406	3	4
7/16-20UNF	GH3	Y85520	4.5P	3.156	0.866	-	0.323	0.242	0.406	3	4
7/16-20UNF	GH5	Y85550	4.5P	3.156	0.866	-	0.323	0.242	0.406	3	4
1/2-13UNC	GH3	Y85521	4.5P	3.375	0.984	-	0.367	0.275	0.437	3	4
1/2-13UNC	GH5	Y85551	4.5P	3.375	0.984	-	0.367	0.275	0.437	3	4
1/2-13UNC	GH7	Y85581	4.5P	3.375	0.984	-	0.367	0.275	0.437	3	4
1/2-20UNF	GH3	Y85522	4.5P	3.375	0.984	-	0.367	0.275	0.437	3	4

3

ANSI

Spiral Fluted Taps
(for blind hole)

①

Spiral Fluted Taps
(for through hole)

②

Spiral Pointed Taps
(for through hole)

③

Hand Taps

④

Cemented Carbide Taps

⑤

Roll Taps

⑥

Special Thread Taps
Simple Inspection Tools

⑦

Pipe Taps

⑧

Thread Mills
Premium Thread Mills

⑨

Dies

⑩

Center Drills
Centering Tools

⑪

Precision Machinery/
Metal Surgical Instruments

⑫

ANSI

③-94

· This product is different from JIS products in shape and dimensions, please be careful when using.

Think threads with
YAMAWA

③ Spiral Pointed Tap Series for through hole

Overall length	Thread length	Thread + Neck length	Shank dia.	Size of square	Length of square
L	ℓ	ℓn	Ds	K	ℓk

ANSI

ZELX NI PO Spiral Pointed Taps for Nickel Base Alloys

Size	Class	Code	Chamfer	L (inch)	ℓ (inch)	ℓn (inch)	Ds (inch)	K (inch)	ℓk (inch)	No. of flutes	TYPE
1/2-20UNF	GH5	Y85552	4.5P	3.375	0.984	-	0.367	0.275	0.437	3	4
1/2-20UNF	GH7	Y85582	4.5P	3.375	0.984	-	0.367	0.275	0.437	3	4
5/8-11UNC	GH3	Y85525	4.5P	3.812	1.083	-	0.48	0.36	0.562	3	4
5/8-11UNC	GH5	Y85555	4.5P	3.812	1.083	-	0.48	0.36	0.562	3	4
5/8-11UNC	GH7	Y85585	4.5P	3.812	1.083	-	0.48	0.36	0.562	3	4
5/8-18UNF	GH3	Y85526	4.5P	3.812	1.083	-	0.48	0.36	0.562	3	4
5/8-18UNF	GH5	Y85556	4.5P	3.812	1.083	-	0.48	0.36	0.562	3	4
5/8-18UNF	GH7	Y85586	4.5P	3.812	1.083	-	0.48	0.36	0.562	3	4
3/4-10UNC	GH3	Y85527	4.5P	4.25	1.201	-	0.59	0.442	0.687	3	4
3/4-10UNC	GH5	Y85557	4.5P	4.25	1.201	-	0.59	0.442	0.687	3	4
3/4-16UNF	GH3	Y85528	4.5P	4.25	1.201	-	0.59	0.442	0.687	3	4
3/4-16UNF	GH5	Y85558	4.5P	4.25	1.201	-	0.59	0.442	0.687	3	4

① Spiral Fluted Taps (for blind hole)

② Spiral Fluted Taps (for through hole)

③ Spiral Pointed Taps (for through hole)

④ Hand Taps

⑤ Cemented Carbide Taps

⑥ Roll Taps

⑦ Special Thread Taps (Simple inspection tools)

⑧ Pipe Taps

⑨ Thread Mills (Premium Thread Mills)

⑩ Dies

⑪ Center Drills (Centering Tools)

⑫ Precision Machinery/ Medical Surgical Instruments

ANSI



This product is different from JIS products in shape and dimensions, please be careful when using.