

Overall length	Thread length	Position on basic dia.	Shank dia.	Size of square	Length of square
L	ℓ	ℓ_g	Ds	K	ℓ_k

JIS

① Spiral Fluted Taps (for blind hole)

② Spiral Fluted Taps (for through hole)

③ Spiral Pointed Taps (for through hole)

④ Hand Taps

⑤ Cemented Carbide Taps

⑥ Roll Taps

⑦ Special Thread Taps (Simple inspection tools)

⑧ Pipe Taps

⑨ Thread Mills (Premium Thread Mills)

⑩ Dies

⑪ Center Drills (Centering Tools)

⑫ Precision Machinery (Medical Surgical Instruments)

JIS

⑧-31



S-PT

Hand Taps for Taper Pipe Threads Short (ℓ_g) Type



Specification



Tapping Speeds depending on Materials

Medium carbon steels 中炭素鋼	High carbon steels 高炭素鋼	Alloy steels 合金鋼
~5 (m/min)	~5 (m/min)	~5 (m/min)

■ The S-PT is a tapered pipe hand tap used for tapping when it is necessary to shorten the fitting length and is used in thread tapping of products such as parts for pipes.

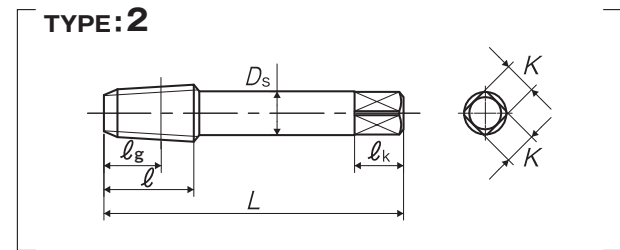
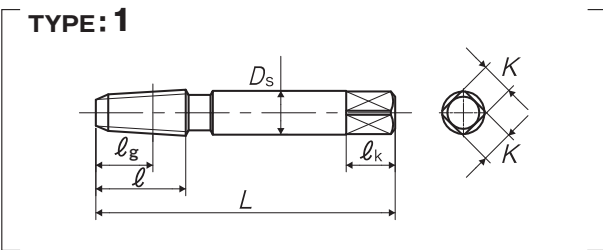

Segment : 1G

Size	Class	Code	Chamfer	Basic major dia (mm)	L (mm)	ℓ (mm)	ℓ_g (mm)	Ds (mm)	K (mm)	ℓ_k (mm)	No. of flutes	TYPE	MSRP
For Pipe Threads													
PT 1/16-28	II	TSPT01K-8	2.5P	7.723	55	16.5	10.5	8	6	9	4	1	¥ 3,740
PT 1/8-28	II	TSPT02K	2.5P	9.728	55	16.5	10.5	8	6	9	4	2	¥ 3,740
PT 1/4-19	II	TSPT04-	2.5P	13.157	62	19.5	12.5	11	9	12	4	2	¥ 5,770
PT 3/8-19	II	TSPT06-	2.5P	16.662	65	21	14	14	11	14	4	2	¥ 9,480
PT 1/2-14	II	TSPT08Q	2.5P	20.955	80	27	17	18	14	17	4	2	¥ 15,700
PT 3/4-14	II	TSPT12Q	2.5P	26.441	85	29	19	23	17	20	4	2	¥ 24,900
PT 1 -11	II	TSPT16U	2.5P	33.249	95	35	22	26	21	24	5	2	¥ 45,800
PT 1 1/4-11	II	TSPT20U	2.5P	41.910	105	37.5	24.5	32	26	30	5	2	¥ 69,200
PT 1 1/2-11	II	TSPT24U	2.5P	47.803	110	38.5	25.5	38	29	32	6	2	¥ 96,800
PT 1 3/4-11	II	TSPT28U	2.5P	53.746	115	39.5	26.5	42	32	35	6	2	¥ 144,000 ^{**}
PT 2 -11	II	TSPT32U	2.5P	59.614	120	42.5	27.5	46	35	38	6	2	¥ 158,000
PT 2 1/2-11	II	TSPT40U	2.5P	75.184	145	47	32	55	41	44	8	2	¥ 264,000 ^{**}
PT 3 -11	II	TSPT48U	2.5P	87.884	155	51	36	65	50	52	8	2	¥ 396,000 ^{**}