

Overall length	Thread length	Position on basic dia.	Shank length	Shank dia.	Size of square	Length of square
L	l	lg	ls	Ds	K	lk

JIS

① Spiral Fluted Taps (for blind hole)

② Spiral Fluted Taps (for through hole)

③ Spiral Pointed Taps (for through hole)

④ Hand Taps

⑤ Cemented Carbide Taps

⑥ Roll Taps

⑦ Special Thread Taps (Simple inspection tools)

⑧ Pipe Taps

⑨ Thread Mills (Premium Thread Mills)

⑩ Dies

⑪ Center Drills (Centering Tools)

⑫ Precision Machinery/ (Medical Surgical Instruments)

JIS

⑧-13



## Rc

### Hand Taps for Taper Pipe Threads



#### Specification



■ The Rc is a hand tap for a tapered pipe threads conforming to ISO specifications. It is used for mating with external tapered pipe threads R(PT).

#### Tapping Speeds depending on Materials

Medium carbon steels 中炭素鋼	High carbon steels 高炭素鋼	Alloy steels 合金鋼
~5 (m/min)	~5 (m/min)	~5 (m/min)

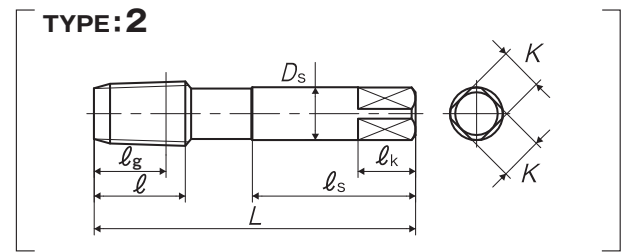
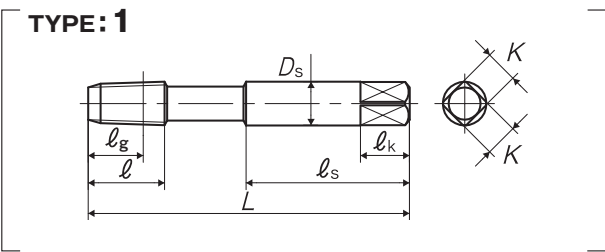

Segment: 1G

Size	Class	Code	Chamfer	Basic major dia (mm)	L (mm)	l (mm)	lg (mm)	ls (mm)	Ds (mm)	K (mm)	lk (mm)	No. of flutes	TYPE	MSRP
For Pipe Threads														
Rc 1/16-28	II	TH2RC01K	2.5P	7.723	59	14	10.1	30	8	6	9	4	1	¥ 3,450
Rc 1/8-28	II	TH2RC02K	2.5P	9.728	59	15	10.1	30	8	6	9	4	2	¥ 3,450
Rc 1/4-19	II	TH2RC04-	2.5P	13.157	67	19	15	34	11	9	12	4	2	¥ 4,930
Rc 3/8-19	II	TH2RC06-	2.5P	16.662	75	21	15.4	38	14	11	14	4	2	¥ 8,100
Rc 1/2-14	II	TH2RC08Q	2.5P	20.955	87	26	20.5	44	18	14	17	4	2	¥ 13,400
Rc 3/4-14	II	TH2RC12Q	2.5P	26.441	96	28	21.8	49	23	17	20	4	2	¥ 21,600
Rc 1 -11	II	TH2RC16U	2.5P	33.249	109	33	26	56	26	21	24	5	2	¥ 39,800
Rc 1 1/4-11	II	TH2RC20U	2.5P	41.910	119	36	28.3	61	32	26	30	5	2	¥ 60,100
Rc 1 1/2-11	II	TH2RC24U	2.5P	47.803	125	37	28.3	64	38	29	32	6	2	¥ 84,100
Rc 2 -11	II	TH2RC32U	2.5P	59.614	140	41	32.7	71	46	35	38	6	2	¥ 137,000