

③ Spiral Pointed Tap Series for through hole

Overall length	Thread length	Thread + Neck length	Shank length	Shank dia.	Size of square	Length of square
L	ℓ	ℓ _n	ℓ _s	D _s	K	ℓ _k

- ANSI
- ① Spiral Fluted Taps (for blind hole)
- ② Spiral Fluted Taps (for through hole)
- ③ Spiral Pointed Taps (for through hole)
- ④ Hand Taps
- ⑤ Cemented Carbide Taps
- ⑥ Roll Taps
- ⑦ Special Thread Taps
- ⑧ Pipe Taps
- ⑨ Thread Mills Premium Thread Mills
- ⑩ Simple Inspection Tools Related Products
- ⑪ Dies
- ⑫ Center Drills Centering Tools
- ⑬ Precision Machinery/Medical Surgical Instruments

ANSI

PO OX

Spiral Pointed Taps, Oxidized



Specification



■ The +PO is a spiral pointed tap for through hole tapping and is suitable for synchronous feed processing in middle to high thread processing of soft steel materials whose chips easily weld to the taps thread such as low carbon steels.

Tapping Speed depending on Materials

Low carbon steels 低碳素鋼	Medium carbon steels 中炭素鋼	High carbon steels 高炭素鋼
5~10 (m/min)	5~10 (m/min)	5~10 (m/min)

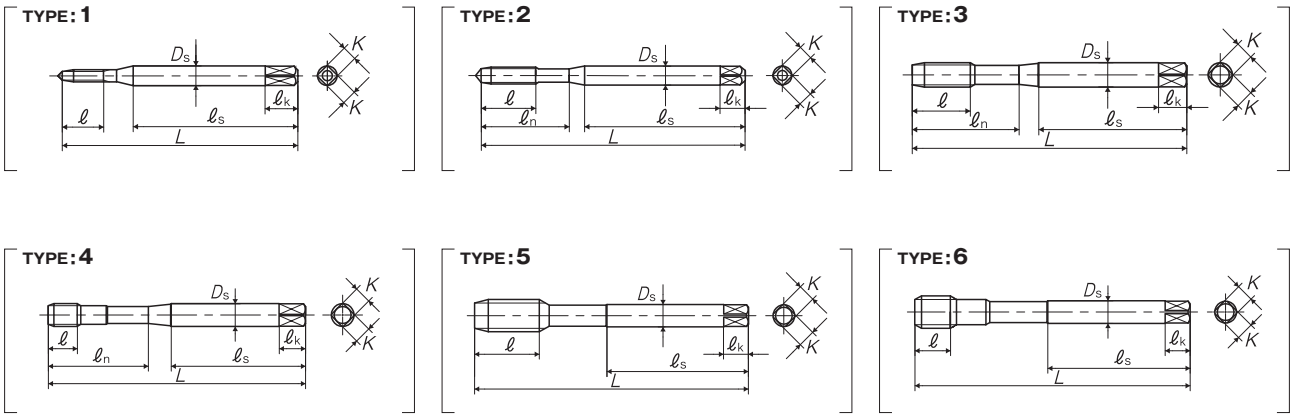

Segment : 1E

Size	Class	Code	Chamfer	L (inch)	ℓ (inch)	ℓ _n (inch)	ℓ _s (inch)	D _s (inch)	K (inch)	ℓ _k (inch)	No. of flutes	TYPE
For Metric Threads												
M2 × 0.4	D3	PS2.0E3NEX	5P	1.772	0.314	-	1.161	0.141	0.110	0.187	3	1
M2.2 × 0.45	D3	PS2.2F3NEX	5P	1.772	0.314	-	1.161	0.141	0.110	0.187	3	1
M2.5 × 0.45	D3	PS2.5F3NEX	5P	2.205	0.354	0.693	1.280	0.141	0.110	0.187	3	2
M2.6 × 0.45	D3	PS2.6F3NEX	5P	2.205	0.354	0.709	1.280	0.141	0.110	0.187	3	2
M3 × 0.5	D3	PS3.0G3NEX	5P	2.205	0.433	0.736	1.339	0.141	0.110	0.187	3	2
M3.5 × 0.6	D4	PS3.5H4NEX	5P	2.205	0.433	0.748	1.339	0.141	0.110	0.187	3	2
M4 × 0.7	D4	PS4.0I4NEX	5P	2.480	0.512	0.815	1.535	0.168	0.131	0.250	3	2
M5 × 0.8	D4	PS5.0K4NEX	5P	2.756	0.551	0.984	1.654	0.194	0.152	0.250	3	2
M6 × 1	D5	PS6.0M5NEX	5P	3.150	0.591	1.181	1.713	0.255	0.191	0.312	3	2
M7 × 1	D5	PS7.0M5NEX	5P	3.543	0.748	1.339	1.831	0.318	0.238	0.375	3	3
M7 × 0.75	D4	PS7.0J4NEX	5P	3.543	0.748	1.339	1.831	0.318	0.238	0.375	3	3
M7 × 0.5	D4	PS7.0G4NEX	5P	3.543	0.394	1.339	1.831	0.318	0.238	0.375	3	4
M8 × 1.25	D5	PS8.0N5NEX	5P	3.543	0.748	1.378	1.831	0.318	0.238	0.375	3	3
M8 × 1	D5	PS8.0M5NEX	5P	3.543	0.748	1.378	1.831	0.318	0.238	0.375	3	3
M8 × 0.75	D4	PS8.0J4NEX	5P	3.543	0.748	1.378	1.831	0.318	0.238	0.375	3	3
M8 × 0.5	D4	PS8.0G4NEX	5P	3.543	0.394	1.378	1.831	0.318	0.238	0.375	3	4
M9 × 1.25	D5	PS9.0N5NEX	5P	3.937	0.906	1.535	2.028	0.381	0.286	0.437	3	3
M9 × 1	D5	PS9.0M5NEX	5P	3.937	0.906	1.535	2.028	0.381	0.286	0.437	3	3
M10 × 1.5	D6	PS10.0O6NEX	5P	3.937	0.906	1.535	2.126	0.381	0.286	0.437	3	3
M10 × 1.25	D5	PS10.0N5NEX	5P	3.937	0.906	1.535	2.126	0.381	0.286	0.437	3	3

ANSI



· This product is different from JIS products in shape and dimensions, please be careful when using.

Overall length	Thread length	Thread + Neck length	Shank length	Shank dia.	Size of square	Length of square
L	ℓ	ℓn	ℓs	Ds	K	ℓk

Size	Class	Code	Chamfer	L (inch)	ℓ (inch)	ℓn (inch)	ℓs (inch)	Ds (inch)	K (inch)	ℓk (inch)	No. of flutes	TYPE
M10 × 1	D5	PS010M5NEX	5P	3.937	0.906	1.535	2.126	0.381	0.286	0.437	3	3
M10 × 0.75	D4	PS010J4NEX	5P	3.937	0.512	1.535	2.126	0.381	0.286	0.437	3	4
M11 × 1.5	D6	PS011O6NEX	5P	3.937	0.906	-	2.008	0.323	0.242	0.406	3	5
M12 × 1.75	D6	PS012P6NEX	5P	4.331	1.024	-	2.205	0.367	0.275	0.437	3	5
M12 × 1.5	D6	PS012O6NEX	5P	4.331	1.024	-	2.205	0.367	0.275	0.437	3	5
M12 × 1.25	D6	PS012N6NEX	5P	4.331	1.024	-	2.205	0.367	0.275	0.437	3	5
M12 × 1	D5	PS012M5NEX	5P	4.331	1.024	-	2.205	0.367	0.275	0.437	3	5
M14 × 2	D7	PS014Q7NEX	5P	4.331	1.024	-	2.205	0.429	0.322	0.500	3	5
M14 × 1.5	D6	PS014O6NEX	5P	4.331	1.024	-	2.205	0.429	0.322	0.500	3	5
M14 × 1.25	D6	PS014N6NEX	5P	4.331	1.024	-	2.205	0.429	0.322	0.500	3	5
M14 × 1	D5	PS014M5NEX	5P	4.331	1.024	-	2.205	0.429	0.322	0.500	3	5
M16 × 2	D7	PS016Q7NEX	5P	4.331	1.024	-	2.205	0.480	0.360	0.562	3	5
M16 × 1.5	D6	PS016O6NEX	5P	4.331	1.024	-	2.205	0.480	0.360	0.562	3	5
M16 × 1	D5	PS016M5NEX	5P	4.331	1.024	-	2.205	0.480	0.360	0.562	3	5
M18 × 2.5	D7	PS018R7NEX	5P	4.921	1.299	-	2.520	0.542	0.406	0.625	3	5
M18 × 2	D7	PS018Q7NEX	5P	4.921	1.299	-	2.520	0.542	0.406	0.625	3	5
M18 × 1.5	D6	PS018O6NEX	5P	4.921	0.945	-	2.520	0.542	0.406	0.625	3	6
M18 × 1	D5	PS018M5NEX	5P	4.921	0.945	-	2.520	0.542	0.406	0.625	3	6
M20 × 2.5	D7	PS020R7NEX	5P	5.512	1.299	-	2.795	0.652	0.489	0.687	3	5
M20 × 2	D7	PS020Q7NEX	5P	5.512	1.299	-	2.795	0.652	0.489	0.687	3	5
M20 × 1.5	D6	PS020O6NEX	5P	5.512	0.945	-	2.795	0.652	0.489	0.687	3	6
M20 × 1	D5	PS020M5NEX	5P	5.512	0.945	-	2.795	0.652	0.489	0.687	3	6
M22 × 2.5	D7	PS022R7NEX	5P	5.512	1.299	-	2.795	0.697	0.523	0.750	3	5
M22 × 2	D7	PS022Q7NEX	5P	5.512	1.299	-	2.795	0.697	0.523	0.750	3	5
M22 × 1.5	D6	PS022O6NEX	5P	5.512	0.945	-	2.795	0.697	0.523	0.750	3	6
M22 × 1	D5	PS022M5NEX	5P	5.512	0.945	-	2.795	0.697	0.523	0.750	3	6
M24 × 3	D8	PS024S8NEX	5P	6.299	1.457	-	3.228	0.760	0.570	0.750	3	5
M24 × 2	D7	PS024Q7NEX	5P	6.299	1.063	-	3.228	0.760	0.570	0.750	3	6
M24 × 1.5	D6	PS024O6NEX	5P	6.299	1.063	-	3.228	0.760	0.570	0.750	3	6
M24 × 1	D5	PS024M5NEX	5P	6.299	1.063	-	3.228	0.760	0.570	0.750	3	6
M25 × 1.5	D6	PS025O6NEX	5P	6.299	1.063	-	3.228	0.800	0.600	0.812	3	6
M26 × 1.5	D6	PS026O6NEX	5P	7.087	1.063	-	3.622	0.896	0.672	0.875	4	6
M27 × 3	D8	PS027S8NEX	5P	7.087	1.732	-	3.622	0.896	0.672	0.875	4	5
M27 × 2	D7	PS027Q7NEX	5P	7.087	1.063	-	3.622	0.896	0.672	0.875	4	6
M27 × 1.5	D6	PS027O6NEX	5P	7.087	1.063	-	3.622	0.896	0.672	0.875	4	6
M27 × 1	D5	PS027M5NEX	5P	7.087	1.063	-	3.622	0.896	0.672	0.875	4	6
M28 × 2	D7	PS028Q7NEX	5P	7.087	1.063	-	3.622	0.896	0.672	0.875	4	6
M28 × 1.5	D6	PS028O6NEX	5P	7.087	1.063	-	3.622	0.896	0.672	0.875	4	6
M28 × 1	D5	PS028M5NEX	5P	7.087	1.063	-	3.622	0.896	0.672	0.875	4	6
M30 × 3.5	D9	PS030T9NEX	5P	7.087	1.732	-	3.622	1.021	0.766	1.000	4	5
M30 × 2	D7	PS030Q7NEX	5P	7.087	1.063	-	3.622	1.021	0.766	1.000	4	5
M30 × 1.5	D6	PS030O6NEX	5P	7.087	1.063	-	3.622	1.021	0.766	1.000	4	5
M30 × 1	D5	PS030M5NEX	5P	7.087	1.063	-	3.622	1.021	0.766	1.000	4	5
M32 × 2	D7	PS032Q7NEX	5P	7.087	1.063	-	3.622	1.021	0.766	1.000	4	5
M32 × 1.5	D6	PS032O6NEX	5P	7.087	1.063	-	3.622	1.021	0.766	1.000	4	5
M32 × 1	D5	PS032M5NEX	5P	7.087	1.063	-	3.622	1.021	0.766	1.000	4	5
M33 × 3.5	D9	PS033T9NEX	5P	7.087	1.732	-	3.622	1.108	0.831	1.062	4	5
M33 × 2	D7	PS033Q7NEX	5P	7.087	1.142	-	3.622	1.108	0.831	1.062	4	6
M33 × 1.5	D6	PS033O6NEX	5P	7.087	1.142	-	3.622	1.108	0.831	1.062	4	6
M33 × 1	D5	PS033M5NEX	5P	7.087	1.142	-	3.622	1.108	0.831	1.062	4	6

3

ANSI

Spiral Fluted Taps
(for blind hole)

①

Spiral Fluted Taps
(for through hole)

②

Spiral Pointed Taps
(for through hole)

③

Hand Taps

④

Cemented
Carbide Taps

⑤

Roll Taps

⑥

Special Thread Taps

⑦

Pipe Taps

⑧

Thread Mills
Premium Thread Mills

⑨

Simple Inspection Tools
Related Products

⑩

Dies

⑪

Center Drills
Centering Tools

⑫

Precision Machinery/
Medical Surgical Instruments

⑬

3 Spiral Pointed Tap Series for through hole

Overall length	Thread length	Thread + Neck length	Shank length	Shank dia.	Size of square	Length of square
L	ℓ	ℓn	ℓs	Ds	K	ℓk

- ① Spiral Fluted Taps (for blind hole)
- ② Spiral Fluted Taps (for through hole)
- ③ Spiral Pointed Taps (for through hole)
- ④ Hand Taps
- ⑤ Cemented Carbide Taps
- ⑥ Roll Taps
- ⑦ Special Thread Taps
- ⑧ Pipe Taps
- ⑨ Thread Mills Premium Thread Mills
- ⑩ Simple Inspection Tools Related Products
- ⑪ Dies
- ⑫ Center Drills Centering Tools
- ⑬ Precision Machinery/ Medical Surgical Instruments

PO OX Spiral Pointed Taps, Oxidized

Size	Class	Code	Chamfer	L (inch)	ℓ (inch)	ℓn (inch)	ℓs (inch)	Ds (inch)	K (inch)	ℓk (inch)	No. of flutes	TYPE
M36 × 4	D9	PS036U9NEX	5P	7.874	2.047	-	4.016	1.233	0.925	1.125	4	5
M36 × 3	D8	PS036S8NEX	5P	7.874	2.047	-	4.016	1.233	0.925	1.125	4	5
M36 × 2	D7	PS036Q7NEX	5P	7.874	1.142	-	4.016	1.233	0.925	1.125	4	6
M36 × 1.5	D6	PS036O6NEX	5P	7.874	1.142	-	4.016	1.233	0.925	1.125	4	6
M36 × 1	D5	PS036M5NEX	5P	7.874	1.142	-	4.016	1.233	0.925	1.125	4	6
M39 × 4	D9	PS039U9NEX	5P	7.874	2.047	-	4.016	1.305	0.979	1.125	4	5
M39 × 3	D8	PS039S8NEX	5P	7.874	2.047	-	4.016	1.305	0.979	1.125	4	5
M39 × 2	D7	PS039Q7NEX	5P	7.874	1.142	-	4.016	1.305	0.979	1.125	4	6
M39 × 1.5	D6	PS039O6NEX	5P	7.874	1.142	-	4.016	1.305	0.979	1.125	4	6
M39 × 1	D5	PS039M5NEX	5P	7.874	1.142	-	4.016	1.305	0.979	1.125	4	6
M42 × 4.5	D10	PS042VONEX	5P	7.874	2.047	-	4.016	1.430	1.072	1.250	4	5
M42 × 2	D7	PS042Q7NEX	5P	7.874	1.142	-	4.016	1.430	1.072	1.250	4	6
M42 × 1.5	D6	PS042O6NEX	5P	7.874	1.142	-	4.016	1.430	1.072	1.250	4	6
M42 × 1	D5	PS042M5NEX	5P	7.874	1.142	-	4.016	1.430	1.072	1.250	4	6
M45 × 4.5	D10	PS045VONEX	5P	8.661	2.323	-	4.409	1.519	1.139	1.250	4	5
M45 × 3	D8	PS045S8NEX	5P	8.661	2.323	-	4.409	1.519	1.139	1.250	4	5
M45 × 2	D7	PS045Q7NEX	5P	8.661	1.220	-	4.409	1.519	1.139	1.250	4	6
M45 × 1.5	D6	PS045O6NEX	5P	8.661	1.220	-	4.409	1.519	1.139	1.250	4	6
M45 × 1	D5	PS045M5NEX	5P	8.661	1.220	-	4.409	1.519	1.139	1.250	4	6
M48 × 5	D11	PS048W-NEX	5P	9.843	2.559	-	5.039	1.644	1.233	1.375	4	5
M48 × 3	D9	PS048S9NEX	5P	9.843	2.559	-	5.039	1.644	1.233	1.375	4	5
M48 × 2	D7	PS048Q7NEX	5P	9.843	1.220	-	5.039	1.644	1.233	1.375	4	6
M48 × 1.5	D7	PS048O7NEX	5P	9.843	1.220	-	5.039	1.644	1.233	1.375	4	6
M48 × 1	D6	PS048M6NEX	5P	9.843	1.220	-	5.039	1.644	1.233	1.375	4	6
For Unified Threads												
No.0-80UNF	GH1	PSUN0B1NEX	5P	1.772	0.236	-	1.161	0.141	0.110	0.187	2	1
No.0-80UNF	GH2	PSUN0B2NEX	5P	1.772	0.236	-	1.161	0.141	0.110	0.187	2	1
No.1-64UNC	GH1	PSUN1D1NEX	5P	1.772	0.276	-	1.161	0.141	0.110	0.187	2	1
No.1-64UNC	GH2	PSUN1D2NEX	5P	1.772	0.276	-	1.161	0.141	0.110	0.187	2	1
No.1-72UNF	GH1	PSUN1C1NEX	5P	1.772	0.276	-	1.161	0.141	0.110	0.187	2	1
No.1-72UNF	GH2	PSUN1C2NEX	5P	1.772	0.276	-	1.161	0.141	0.110	0.187	2	1
No.2-56UNC	GH1	PSUN2E1NEX	5P	1.772	0.314	-	1.161	0.141	0.110	0.187	2	1
No.2-56UNC	GH2	PSUN2E2NEX	5P	1.772	0.314	-	1.161	0.141	0.110	0.187	2	1
No.2-64UNF	GH1	PSUN2D1NEX	5P	1.772	0.314	-	1.161	0.141	0.110	0.187	2	1
No.2-64UNF	GH2	PSUN2D2NEX	5P	1.772	0.314	-	1.161	0.141	0.110	0.187	2	1
No.3-48UNC	GH1	PSUN3F1NEX	5P	2.205	0.354	0.681	1.280	0.141	0.110	0.187	2	2
No.3-48UNC	GH2	PSUN3F2NEX	5P	2.205	0.354	0.681	1.280	0.141	0.110	0.187	2	2
No.3-56UNF	GH1	PSUN3E1NEX	5P	2.205	0.354	0.681	1.280	0.141	0.110	0.187	2	2
No.3-56UNF	GH2	PSUN3E2NEX	5P	2.205	0.354	0.681	1.280	0.141	0.110	0.187	2	2
No.4-40UNC	GH2	PSUN4H2NEX	5P	2.205	0.354	0.709	1.280	0.141	0.110	0.187	2	2
No.4-40UNC	GH3	PSUN4H3NEX	5P	2.205	0.354	0.709	1.280	0.141	0.110	0.187	2	2
No.4-48UNF	GH1	PSUN4F1NEX	5P	2.205	0.354	0.709	1.280	0.141	0.110	0.187	2	2
No.4-48UNF	GH2	PSUN4F2NEX	5P	2.205	0.354	0.709	1.280	0.141	0.110	0.187	2	2
No.5-40UNC	GH2	PSUN5H2NEX	5P	2.205	0.433	0.736	1.339	0.141	0.110	0.187	2	2
No.5-40UNC	GH3	PSUN5H3NEX	5P	2.205	0.433	0.736	1.339	0.141	0.110	0.187	2	2
No.5-44UNF	GH1	PSUN5G1NEX	5P	2.205	0.433	0.736	1.339	0.141	0.110	0.187	2	2
No.5-44UNF	GH2	PSUN5G2NEX	5P	2.205	0.433	0.736	1.339	0.141	0.110	0.187	2	2
No.5-44UNF	GH3	PSUN5G3NEX	5P	2.205	0.433	0.736	1.339	0.141	0.110	0.187	2	2
No.6-32UNC	GH2	PSUN6J2NEX	5P	2.205	0.433	0.748	1.339	0.141	0.110	0.187	2	2
No.6-32UNC	GH3	PSUN6J3NEX	5P	2.205	0.433	0.748	1.339	0.141	0.110	0.187	2	2

Overall length	Thread length	Thread + Neck length	Shank length	Shank dia.	Size of square	Length of square
L	ℓ	ℓn	ℓs	Ds	K	ℓk

PO OX Spiral Pointed Taps, Oxidized

Size	Class	Code	Chamfer	L (inch)	ℓ (inch)	ℓn (inch)	ℓs (inch)	Ds (inch)	K (inch)	ℓk (inch)	No. of flutes	TYPE
No.6-40UNF	GH2	PSUN6H2NEX	5P	2.205	0.433	0.748	1.339	0.141	0.110	0.187	2	2
No.6-40UNF	GH3	PSUN6H3NEX	5P	2.205	0.433	0.748	1.339	0.141	0.110	0.187	2	2
No.8-32UNC	GH2	PSUN8J2NEX	5P	2.480	0.512	0.827	1.535	0.168	0.131	0.250	2	2
No.8-32UNC	GH3	PSUN8J3NEX	5P	2.480	0.512	0.827	1.535	0.168	0.131	0.250	2	2
No.8-36UNF	GH2	PSUN8I2NEX	5P	2.480	0.512	0.827	1.535	0.168	0.131	0.250	2	2
No.8-36UNF	GH3	PSUN8I3NEX	5P	2.480	0.512	0.827	1.535	0.168	0.131	0.250	2	2
No.10-24UNC	GH2	PSUNAM2NEX	5P	2.756	0.551	0.945	1.654	0.194	0.152	0.250	2	2
No.10-24UNC	GH3	PSUNAM3NEX	5P	2.756	0.551	0.945	1.654	0.194	0.152	0.250	2	2
No.10-32UNF	GH2	PSUNAJ2NEX	5P	2.756	0.551	0.945	1.654	0.194	0.152	0.250	2	2
No.10-32UNF	GH3	PSUNAJ3NEX	5P	2.756	0.551	0.945	1.654	0.194	0.152	0.250	2	2
No.12-24UNC	GH2	PSUNCM2NEX	5P	3.150	0.591	0.984	1.953	0.220	0.165	0.281	2	2
No.12-24UNC	GH3	PSUNCM3NEX	5P	3.150	0.591	0.984	1.953	0.220	0.165	0.281	2	2
No.12-28UNF	GH2	PSUNCK2NEX	5P	3.150	0.591	0.984	1.953	0.220	0.165	0.281	2	2
No.12-28UNF	GH3	PSUNCK3NEX	5P	3.150	0.591	0.984	1.953	0.220	0.165	0.281	2	2
1/4-20UNC	GH3	PSU04N3NEX	4.5P	3.150	0.591	1.181	1.713	0.255	0.191	0.312	3	2
1/4-20UNC	GH4	PSU04N4NEX	4.5P	3.150	0.591	1.181	1.713	0.255	0.191	0.312	3	2
1/4-20UNC	GH5	PSU04N5NEX	4.5P	3.150	0.591	1.181	1.713	0.255	0.191	0.312	3	2
1/4-28UNF	GH2	PSU04K2NEX	4.5P	3.150	0.591	1.181	1.713	0.255	0.191	0.312	3	2
1/4-28UNF	GH3	PSU04K3NEX	4.5P	3.150	0.591	1.181	1.713	0.255	0.191	0.312	3	2
1/4-28UNF	GH4	PSU04K4NEX	4.5P	3.150	0.591	1.181	1.713	0.255	0.191	0.312	3	2
5/16-18UNC	GH3	PSU05O3NEX	4.5P	3.543	0.748	1.378	1.831	0.318	0.238	0.375	3	3
5/16-18UNC	GH4	PSU05O4NEX	4.5P	3.543	0.748	1.378	1.831	0.318	0.238	0.375	3	3
5/16-18UNC	GH5	PSU05O5NEX	4.5P	3.543	0.748	1.378	1.831	0.318	0.238	0.375	3	3
5/16-24UNF	GH3	PSU05M3NEX	4.5P	3.543	0.748	1.378	1.831	0.318	0.238	0.375	3	3
5/16-24UNF	GH4	PSU05M4NEX	4.5P	3.543	0.748	1.378	1.831	0.318	0.238	0.375	3	3
3/8-16UNC	GH3	PSU06P3NEX	4.5P	3.937	0.906	1.535	2.028	0.381	0.286	0.437	3	3
3/8-16UNC	GH5	PSU06P5NEX	4.5P	3.937	0.906	1.535	2.028	0.381	0.286	0.437	3	3
3/8-24UNF	GH3	PSU06M3NEX	4.5P	3.937	0.906	1.535	2.028	0.381	0.286	0.437	3	3
3/8-24UNF	GH4	PSU06M4NEX	4.5P	3.937	0.906	1.535	2.028	0.381	0.286	0.437	3	3
7/16-14UNC	GH4	PSU07Q4NEX	4.5P	3.937	0.906	-	2.008	0.323	0.242	0.406	3	5
7/16-14UNC	GH5	PSU07Q5NEX	4.5P	3.937	0.906	-	2.008	0.323	0.242	0.406	3	5
7/16-20UNF	GH3	PSU07N3NEX	4.5P	3.937	0.906	-	2.008	0.323	0.242	0.406	3	5
7/16-20UNF	GH4	PSU07N4NEX	4.5P	3.937	0.906	-	2.008	0.323	0.242	0.406	3	5
7/16-20UNF	GH5	PSU07N5NEX	4.5P	3.937	0.906	-	2.008	0.323	0.242	0.406	3	5
1/2-13UNC	GH3	PSU08R3NEX	4.5P	4.331	1.024	-	2.205	0.367	0.275	0.437	3	5
1/2-13UNC	GH4	PSU08R4NEX	4.5P	4.331	1.024	-	2.205	0.367	0.275	0.437	3	5
1/2-13UNC	GH5	PSU08R5NEX	4.5P	4.331	1.024	-	2.205	0.367	0.275	0.437	3	5
1/2-20UNF	GH3	PSU08N3NEX	4.5P	4.331	1.024	-	2.205	0.367	0.275	0.437	3	5
1/2-20UNF	GH4	PSU08N4NEX	4.5P	4.331	1.024	-	2.205	0.367	0.275	0.437	3	5
1/2-20UNF	GH5	PSU08N5NEX	4.5P	4.331	1.024	-	2.205	0.367	0.275	0.437	3	5
9/16-12UNC	GH3	PSU09S3NEX	4.5P	4.331	1.024	-	2.205	0.429	0.322	0.500	3	5
9/16-12UNC	GH4	PSU09S4NEX	4.5P	4.331	1.024	-	2.205	0.429	0.322	0.500	3	5
9/16-12UNC	GH5	PSU09S5NEX	4.5P	4.331	1.024	-	2.205	0.429	0.322	0.500	3	5
9/16-18UNF	GH3	PSU09O3NEX	4.5P	4.331	1.024	-	2.205	0.429	0.322	0.500	3	5
9/16-18UNF	GH4	PSU09O4NEX	4.5P	4.331	1.024	-	2.205	0.429	0.322	0.500	3	5
9/16-18UNF	GH5	PSU09O5NEX	4.5P	4.331	1.024	-	2.205	0.429	0.322	0.500	3	5
5/8-11UNC	GH3	PSU10U3NEX	4.5P	4.331	1.024	-	2.205	0.480	0.360	0.562	3	5
5/8-11UNC	GH4	PSU10U4NEX	4.5P	4.331	1.024	-	2.205	0.480	0.360	0.562	3	5
5/8-11UNC	GH5	PSU10U5NEX	4.5P	4.331	1.024	-	2.205	0.480	0.360	0.562	3	5
5/8-11UNC	GH6	PSU10U6NEX	4.5P	4.331	1.024	-	2.205	0.480	0.360	0.562	3	5

3

ANSI

Spiral Fluted Taps
(for blind hole) ①

Spiral Fluted Taps
(for through hole) ②

Spiral Pointed Taps
(for through hole) ③

Hand Taps ④

Cemented
Carbide Taps ⑤

Roll Taps ⑥

Special Thread Taps ⑦

Pipe Taps ⑧

Thread Mills
Premium Thread Mills ⑨

Simple Inspection Tools
Related Products ⑩

Dies ⑪

Center Drills
Centering Tools ⑫

Precision Machinery/
Medical Surgical Instruments ⑬

· This product is different from JIS products in shape and dimensions, please be careful when using.

3 Spiral Pointed Tap Series for through hole

Overall length	Thread length	Thread + Neck length	Shank length	Shank dia.	Size of square	Length of square
L	ℓ	ℓn	ℓs	Ds	K	ℓk

- ① Spiral Fluted Taps (for blind hole)
- ② Spiral Fluted Taps (for through hole)
- ③ Spiral Pointed Taps (for through hole)
- ④ Hand Taps
- ⑤ Cemented Carbide Taps
- ⑥ Roll Taps
- ⑦ Special Thread Taps
- ⑧ Pipe Taps
- ⑨ Thread Mills Premium Thread Mills
- ⑩ Simple Inspection Tools Related Products
- ⑪ Dies
- ⑫ Center Drills Centering Tools
- ⑬ Precision Machinery/Medical Surgical Instruments

PO OX Spiral Pointed Taps, Oxidized

Size	Class	Code	Chamfer	L (inch)	ℓ (inch)	ℓn (inch)	ℓs (inch)	Ds (inch)	K (inch)	ℓk (inch)	No. of flutes	TYPE
5/8-18UNF	GH3	PSU1003NEX	4.5P	4.331	1.024	-	2.205	0.480	0.360	0.562	3	5
5/8-18UNF	GH4	PSU1004NEX	4.5P	4.331	1.024	-	2.205	0.480	0.360	0.562	3	5
5/8-18UNF	GH5	PSU1005NEX	4.5P	4.331	1.024	-	2.205	0.480	0.360	0.562	3	5
3/4-10UNC	GH5	PSU12V5NEX	4.5P	4.921	1.299	-	2.520	0.590	0.442	0.687	3	5
3/4-10UNC	GH6	PSU12V6NEX	4.5P	4.921	1.299	-	2.520	0.590	0.442	0.687	3	5
3/4-16UNF	GH3	PSU12P3NEX	4.5P	4.921	1.299	-	2.520	0.590	0.442	0.687	3	5
3/4-16UNF	GH4	PSU12P4NEX	4.5P	4.921	1.299	-	2.520	0.590	0.442	0.687	3	5
3/4-16UNF	GH5	PSU12P5NEX	4.5P	4.921	1.299	-	2.520	0.590	0.442	0.687	3	5
7/8-9UNC	GH4	PSU14W4NEX	4.5P	5.512	1.299	-	2.795	0.697	0.523	0.750	3	5
7/8-9UNC	GH5	PSU14W5NEX	4.5P	5.512	1.299	-	2.795	0.697	0.523	0.750	3	5
7/8-9UNC	GH6	PSU14W6NEX	4.5P	5.512	1.299	-	2.795	0.697	0.523	0.750	3	5
7/8-14UNF	GH4	PSU14Q4NEX	4.5P	5.512	1.299	-	2.795	0.697	0.523	0.750	3	5
7/8-14UNF	GH6	PSU14Q6NEX	4.5P	5.512	1.299	-	2.795	0.697	0.523	0.750	3	5
1 -8UNC	GH4	PSU16X4NEX	4.5P	6.299	1.457	-	3.228	0.800	0.600	0.812	3	5
1 -8UNC	GH5	PSU16X5NEX	4.5P	6.299	1.457	-	3.228	0.800	0.600	0.812	3	5
1 -8UNC	GH6	PSU16X6NEX	4.5P	6.299	1.457	-	3.228	0.800	0.600	0.812	3	5
1 -8UNC	GH7	PSU16X7NEX	4.5P	6.299	1.457	-	3.228	0.800	0.600	0.812	3	5
1 -12UNF	GH4	PSU16S4NEX	4.5P	6.299	1.457	-	3.228	0.800	0.600	0.812	3	5
1 -12UNF	GH5	PSU16S5NEX	4.5P	6.299	1.457	-	3.228	0.800	0.600	0.812	3	5
1 -12UNF	GH6	PSU16S6NEX	4.5P	6.299	1.457	-	3.228	0.800	0.600	0.812	3	5
1 1/8-7UNC	GH6	PSU18Y6NEX	4.5P	7.087	1.732	-	3.622	0.896	0.672	0.875	4	5
1 1/8-7UNC	GH7	PSU18Y7NEX	4.5P	7.087	1.732	-	3.622	0.896	0.672	0.875	4	5
1 1/8-12UNF	GH5	PSU18S5NEX	4.5P	7.087	1.732	-	3.622	0.896	0.672	0.875	4	5
1 1/8-12UNF	GH6	PSU18S6NEX	4.5P	7.087	1.732	-	3.622	0.896	0.672	0.875	4	5
1 1/4-7UNC	GH6	PSU20Y6NEX	4.5P	7.087	1.929	-	3.622	1.021	0.766	1.000	4	5
1 1/4-7UNC	GH8	PSU20Y8NEX	4.5P	7.087	1.929	-	3.622	1.021	0.766	1.000	4	5
1 1/4-12UNF	GH5	PSU20S5NEX	4.5P	7.087	1.929	-	3.622	1.021	0.766	1.000	4	5
1 1/4-12UNF	GH6	PSU20S6NEX	4.5P	7.087	1.929	-	3.622	1.021	0.766	1.000	4	5
1 3/8-6UNC	GH6	PSU22Z6NEX	4.5P	7.874	2.165	-	4.016	1.108	0.831	1.062	4	5
1 3/8-6UNC	GH8	PSU22Z8NEX	4.5P	7.874	2.165	-	4.016	1.108	0.831	1.062	4	5
1 3/8-12UNF	GH5	PSU22S5NEX	4.5P	7.874	2.165	-	4.016	1.108	0.831	1.062	4	5
1 3/8-12UNF	GH6	PSU22S6NEX	4.5P	7.874	2.165	-	4.016	1.108	0.831	1.062	4	5
1 1/2-6UNC	GH6	PSU24Z6NEX	4.5P	7.874	2.323	-	4.016	1.233	0.925	1.125	4	5
1 1/2-6UNC	GH8	PSU24Z8NEX	4.5P	7.874	2.323	-	4.016	1.233	0.925	1.125	4	5
1 1/2-12UNF	GH5	PSU24S5NEX	4.5P	7.874	2.323	-	4.016	1.233	0.925	1.125	4	5
1 1/2-12UNF	GH7	PSU24S7NEX	4.5P	7.874	2.323	-	4.016	1.233	0.925	1.125	4	5