

# 4 Hand Tap Series

Overall length	Thread length	Thread + Neck length	Shank length	Shank dia.	Size of square	Length of square
L	ℓ	ℓ <sub>n</sub>	ℓ <sub>s</sub>	D <sub>s</sub>	K	ℓ <sub>k</sub>

- ① Spiral Fluted Taps (for blind hole)
- ② Spiral Fluted Taps (for through hole)
- ③ Spiral Pointed Taps (for through hole)
- ④ Hand Taps



## HT Hand Taps



### Specification



### Tapping Speed depending on Materials

Low carbon steels 低炭素鋼	Medium carbon steels 中炭素鋼	High carbon steels 高炭素鋼
5~10 (m/min)	5~10 (m/min)	5~10 (m/min)

■ The HT taps produce a chip that is relatively small and is stored in the taps flutes. The HT taps have a high cutting edge strength and can be used on a wide variety of machines from manual drilling machines and machining centers.

- ⑤ Cemented Carbide Taps
- ⑥ Roll Taps
- ⑦ Special Thread Taps (Simple inspection tools)
- ⑧ Pipe Taps

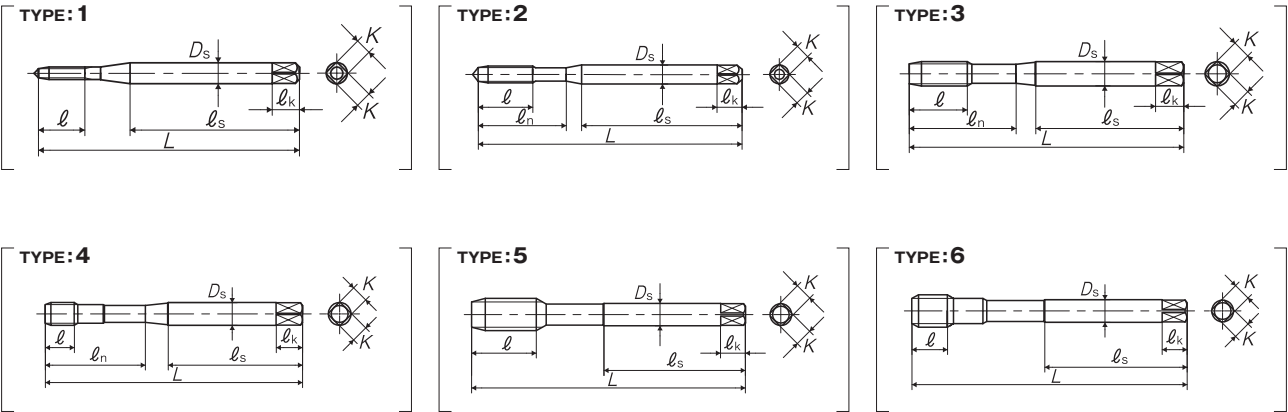

- ⑨ Thread Mills (Premium Thread Mills)
- ⑩ Dies
- ⑪ Center Drills (Centering Tools)
- ⑫ Precision Machinery/ Medical Surgical Instruments

Segment : 1A

Size	Class	Code	Chamfer	L (inch)	ℓ (inch)	ℓ <sub>n</sub> (inch)	ℓ <sub>s</sub> (inch)	D <sub>s</sub> (inch)	K (inch)	ℓ <sub>k</sub> (inch)	No. of flutes	TYPE
For Metric Threads												
M2 × 0.4	D3	TS2.0E3NEB5	5P	1.772	0.314	-	1.161	0.141	0.11	0.187	3	1
M2 × 0.4	D3	TS2.0E3NEBA	1.5P	1.772	0.314	-	1.161	0.141	0.11	0.187	3	1
M2.2 × 0.45	D3	TS2.2F3NEB5	5P	1.772	0.314	-	1.161	0.141	0.11	0.187	3	1
M2.2 × 0.45	D3	TS2.2F3NEBA	1.5P	1.772	0.314	-	1.161	0.141	0.11	0.187	3	1
M2.5 × 0.45	D3	TS2.5F3NEB5	5P	2.205	0.354	0.693	1.28	0.141	0.11	0.187	3	2
M2.5 × 0.45	D3	TS2.5F3NEBA	1.5P	2.205	0.354	0.693	1.28	0.141	0.11	0.187	3	2
M2.6 × 0.45	D3	TS2.6F3NEB5	5P	2.205	0.354	0.709	1.28	0.141	0.11	0.187	3	2
M2.6 × 0.45	D3	TS2.6F3NEBA	1.5P	2.205	0.354	0.709	1.28	0.141	0.11	0.187	3	2
M3 × 0.5	D3	TS3.0G3NEB5	5P	2.205	0.433	0.736	1.339	0.141	0.11	0.187	3	2
M3 × 0.5	D3	TS3.0G3NEBA	1.5P	2.205	0.433	0.736	1.339	0.141	0.11	0.187	3	2
M3.5 × 0.6	D4	TS3.5H4NEB5	5P	2.205	0.433	0.748	1.339	0.141	0.11	0.187	3	2
M3.5 × 0.6	D4	TS3.5H4NEBA	1.5P	2.205	0.433	0.748	1.339	0.141	0.11	0.187	3	2



# 4 Hand Tap Series

Overall length	Thread length	Thread + Neck length	Shank length	Shank dia.	Size of square	Length of square
L	ℓ	ℓn	ℓs	Ds	K	ℓk

- ① Spiral Fluted Taps (for blind hole)
- ② Spiral Fluted Taps (for through hole)
- ③ Spiral Pointed Taps (for through hole)
- ④ Hand Taps
- ⑤ Cemented Carbide Taps
- ⑥ Roll Taps
- ⑦ Special Thread Taps (Simple inspection tools)
- ⑧ Pipe Taps
- ⑨ Thread Mills (Premium Thread Mills)
- ⑩ Dies
- ⑪ Center Drills (Centering Tools)
- ⑫ Precision Machinery/ Medical Surgical Instruments

## HT Hand Taps

Size	Class	Code	Chamfer	L (inch)	ℓ (inch)	ℓn (inch)	ℓs (inch)	Ds (inch)	K (inch)	ℓk (inch)	No. of flutes	TYPE
M16 × 2	D7	TS016Q7NEB5	5P	4.331	1.024	-	2.205	0.48	0.36	0.562	4	5
M16 × 2	D7	TS016Q7NEBA	1.5P	4.331	1.024	-	2.205	0.48	0.36	0.562	4	5
M16 × 1.5	D6	TS016O6NEB5	5P	4.331	1.024	-	2.205	0.48	0.36	0.562	4	5
M16 × 1.5	D6	TS016O6NEBA	1.5P	4.331	1.024	-	2.205	0.48	0.36	0.562	4	5
M16 × 1	D5	TS016M5NEB5	5P	4.331	1.024	-	2.205	0.48	0.36	0.562	4	5
M16 × 1	D5	TS016M5NEBA	1.5P	4.331	1.024	-	2.205	0.48	0.36	0.562	4	5
M18 × 2.5	D7	TS018R7NEB5	5P	4.921	1.299	-	2.52	0.542	0.406	0.625	4	5
M18 × 2.5	D7	TS018R7NEBA	1.5P	4.921	1.299	-	2.52	0.542	0.406	0.625	4	5
M18 × 2	D7	TS018Q7NEB5	5P	4.921	1.299	-	2.52	0.542	0.406	0.625	4	5
M18 × 2	D7	TS018Q7NEBA	1.5P	4.921	1.299	-	2.52	0.542	0.406	0.625	4	5
M18 × 1.5	D6	TS018O6NEB5	5P	4.921	0.945	-	2.52	0.542	0.406	0.625	4	6
M18 × 1.5	D6	TS018O6NEBA	1.5P	4.921	0.945	-	2.52	0.542	0.406	0.625	4	6
M18 × 1	D5	TS018M5NEB5	5P	4.921	0.945	-	2.52	0.542	0.406	0.625	4	6
M18 × 1	D5	TS018M5NEBA	1.5P	4.921	0.945	-	2.52	0.542	0.406	0.625	4	6
M20 × 2.5	D7	TS020R7NEB5	5P	5.512	1.299	-	2.795	0.652	0.489	0.687	4	5
M20 × 2.5	D7	TS020R7NEBA	1.5P	5.512	1.299	-	2.795	0.652	0.489	0.687	4	5
M20 × 2	D7	TS020Q7NEB5	5P	5.512	1.299	-	2.795	0.652	0.489	0.687	4	5
M20 × 2	D7	TS020Q7NEBA	1.5P	5.512	1.299	-	2.795	0.652	0.489	0.687	4	5
M20 × 1.5	D6	TS020O6NEB5	5P	5.512	0.945	-	2.795	0.652	0.489	0.687	4	6
M20 × 1.5	D6	TS020O6NEBA	1.5P	5.512	0.945	-	2.795	0.652	0.489	0.687	4	6
M20 × 1	D5	TS020M5NEB5	5P	5.512	0.945	-	2.795	0.652	0.489	0.687	4	6
M20 × 1	D5	TS020M5NEBA	1.5P	5.512	0.945	-	2.795	0.652	0.489	0.687	4	6
M22 × 2.5	D7	TS022R7NEB5	5P	5.512	1.299	-	2.795	0.697	0.523	0.75	4	5
M22 × 2.5	D7	TS022R7NEBA	1.5P	5.512	1.299	-	2.795	0.697	0.523	0.75	4	5
M22 × 2	D7	TS022Q7NEB5	5P	5.512	1.299	-	2.795	0.697	0.523	0.75	4	5
M22 × 2	D7	TS022Q7NEBA	1.5P	5.512	1.299	-	2.795	0.697	0.523	0.75	4	5
M22 × 1.5	D6	TS022O6NEB5	5P	5.512	0.945	-	2.795	0.697	0.523	0.75	4	6
M22 × 1.5	D6	TS022O6NEBA	1.5P	5.512	0.945	-	2.795	0.697	0.523	0.75	4	6
M22 × 1	D5	TS022M5NEB5	5P	5.512	0.945	-	2.795	0.697	0.523	0.75	4	6
M22 × 1	D5	TS022M5NEBA	1.5P	5.512	0.945	-	2.795	0.697	0.523	0.75	4	6
M24 × 3	D8	TS024S8NEB5	5P	6.299	1.457	-	3.228	0.76	0.57	0.75	4	5
M24 × 3	D8	TS024S8NEBA	1.5P	6.299	1.457	-	3.228	0.76	0.57	0.75	4	5
M24 × 2	D7	TS024Q7NEB5	5P	6.299	1.063	-	3.228	0.76	0.57	0.75	4	6
M24 × 2	D7	TS024Q7NEBA	1.5P	6.299	1.063	-	3.228	0.76	0.57	0.75	4	6
M24 × 1.5	D6	TS024O6NEB5	5P	6.299	1.063	-	3.228	0.76	0.57	0.75	4	6
M24 × 1.5	D6	TS024O6NEBA	1.5P	6.299	1.063	-	3.228	0.76	0.57	0.75	4	6
M24 × 1	D5	TS024M5NEB5	5P	6.299	1.063	-	3.228	0.76	0.57	0.75	4	6
M24 × 1	D5	TS024M5NEBA	1.5P	6.299	1.063	-	3.228	0.76	0.57	0.75	4	6
M25 × 1.5	D6	TS025O6NEB5	5P	6.299	1.063	-	3.228	0.8	0.6	0.812	4	6
M25 × 1.5	D6	TS025O6NEBA	1.5P	6.299	1.063	-	3.228	0.8	0.6	0.812	4	6
M26 × 1.5	D6	TS026O6NEB5	5P	7.087	1.063	-	3.622	0.896	0.672	0.875	4	6
M26 × 1.5	D6	TS026O6NEBA	1.5P	7.087	1.063	-	3.622	0.896	0.672	0.875	4	6
M27 × 3	D8	TS027S8NEB5	5P	7.087	1.732	-	3.622	0.896	0.672	0.875	4	5
M27 × 3	D8	TS027S8NEBA	1.5P	7.087	1.732	-	3.622	0.896	0.672	0.875	4	5
M27 × 2	D7	TS027Q7NEB5	5P	7.087	1.063	-	3.622	0.896	0.672	0.875	4	6
M27 × 2	D7	TS027Q7NEBA	1.5P	7.087	1.063	-	3.622	0.896	0.672	0.875	4	6
M27 × 1.5	D6	TS027O6NEB5	5P	7.087	1.063	-	3.622	0.896	0.672	0.875	4	6
M27 × 1.5	D6	TS027O6NEBA	1.5P	7.087	1.063	-	3.622	0.896	0.672	0.875	4	6
M27 × 1	D5	TS027M5NEB5	5P	7.087	1.063	-	3.622	0.896	0.672	0.875	4	6
M27 × 1	D5	TS027M5NEBA	1.5P	7.087	1.063	-	3.622	0.896	0.672	0.875	4	6

Overall length	Thread length	Thread + Neck length	Shank length	Shank dia.	Size of square	Length of square
L	ℓ	ℓn	ℓs	Ds	K	ℓk

## HT Hand Taps

Size	Class	Code	Chamfer	L (inch)	ℓ (inch)	ℓn (inch)	ℓs (inch)	Ds (inch)	K (inch)	ℓk (inch)	No. of flutes	TYPE
M28 × 2	D7	TS028Q7NEB5	5P	7.087	1.063	-	3.622	0.896	0.672	0.875	4	6
M28 × 2	D7	TS028Q7NEBA	1.5P	7.087	1.063	-	3.622	0.896	0.672	0.875	4	6
M28 × 1.5	D6	TS028O6NEB5	5P	7.087	1.063	-	3.622	0.896	0.672	0.875	4	6
M28 × 1.5	D6	TS028O6NEBA	1.5P	7.087	1.063	-	3.622	0.896	0.672	0.875	4	6
M28 × 1	D5	TS028M5NEB5	5P	7.087	1.063	-	3.622	0.896	0.672	0.875	4	6
M28 × 1	D5	TS028M5NEBA	1.5P	7.087	1.063	-	3.622	0.896	0.672	0.875	4	6
M30 × 3.5	D9	TS030T9NEB5	5P	7.087	1.732	-	3.622	1.021	0.766	1	4	5
M30 × 3.5	D9	TS030T9NEBA	1.5P	7.087	1.732	-	3.622	1.021	0.766	1	4	5
M30 × 2	D7	TS030Q7NEB5	5P	7.087	1.063	-	3.622	1.021	0.766	1	4	6
M30 × 2	D7	TS030Q7NEBA	1.5P	7.087	1.063	-	3.622	1.021	0.766	1	4	6
M30 × 1.5	D6	TS030O6NEB5	5P	7.087	1.063	-	3.622	1.021	0.766	1	4	6
M30 × 1.5	D6	TS030O6NEBA	1.5P	7.087	1.063	-	3.622	1.021	0.766	1	4	6
M30 × 1	D5	TS030M5NEB5	5P	7.087	1.063	-	3.622	1.021	0.766	1	4	6
M30 × 1	D5	TS030M5NEBA	1.5P	7.087	1.063	-	3.622	1.021	0.766	1	4	6
M32 × 2	D7	TS032Q7NEB5	5P	7.087	1.063	-	3.622	1.021	0.766	1	4	5
M32 × 2	D7	TS032Q7NEBA	1.5P	7.087	1.063	-	3.622	1.021	0.766	1	4	5
M32 × 1.5	D6	TS032O6NEB5	5P	7.087	1.063	-	3.622	1.021	0.766	1	4	5
M32 × 1.5	D6	TS032O6NEBA	1.5P	7.087	1.063	-	3.622	1.021	0.766	1	4	5
M32 × 1	D5	TS032M5NEB5	5P	7.087	1.063	-	3.622	1.021	0.766	1	4	5
M32 × 1	D5	TS032M5NEBA	1.5P	7.087	1.063	-	3.622	1.021	0.766	1	4	5
M33 × 3.5	D9	TS033T9NEB5	5P	7.087	1.732	-	3.622	1.108	0.831	1.062	4	5
M33 × 3.5	D9	TS033T9NEBA	1.5P	7.087	1.732	-	3.622	1.108	0.831	1.062	4	5
M33 × 2	D7	TS033Q7NEB5	5P	7.087	1.142	-	3.622	1.108	0.831	1.062	4	6
M33 × 2	D7	TS033Q7NEBA	1.5P	7.087	1.142	-	3.622	1.108	0.831	1.062	4	6
M33 × 1.5	D6	TS033O6NEB5	5P	7.087	1.142	-	3.622	1.108	0.831	1.062	4	6
M33 × 1.5	D6	TS033O6NEBA	1.5P	7.087	1.142	-	3.622	1.108	0.831	1.062	4	6
M33 × 1	D5	TS033M5NEB5	5P	7.087	1.142	-	3.622	1.108	0.831	1.062	4	6
M33 × 1	D5	TS033M5NEBA	1.5P	7.087	1.142	-	3.622	1.108	0.831	1.062	4	6
M36 × 4	D9	TS036U9NEB5	5P	7.874	2.047	-	4.016	1.233	0.925	1.125	4	5
M36 × 4	D9	TS036U9NEBA	1.5P	7.874	2.047	-	4.016	1.233	0.925	1.125	4	5
M36 × 3	D8	TS036S8NEB5	5P	7.874	2.047	-	4.016	1.233	0.925	1.125	4	5
M36 × 3	D8	TS036S8NEBA	1.5P	7.874	2.047	-	4.016	1.233	0.925	1.125	4	5
M36 × 2	D7	TS036Q7NEB5	5P	7.874	1.142	-	4.016	1.233	0.925	1.125	4	6
M36 × 2	D7	TS036Q7NEBA	1.5P	7.874	1.142	-	4.016	1.233	0.925	1.125	4	6
M36 × 1.5	D6	TS036O6NEB5	5P	7.874	1.142	-	4.016	1.233	0.925	1.125	4	6
M36 × 1.5	D6	TS036O6NEBA	1.5P	7.874	1.142	-	4.016	1.233	0.925	1.125	4	6
M36 × 1	D5	TS036M5NEB5	5P	7.874	1.142	-	4.016	1.233	0.925	1.125	4	6
M36 × 1	D5	TS036M5NEBA	1.5P	7.874	1.142	-	4.016	1.233	0.925	1.125	4	6
M39 × 4	D9	TS039U9NEB5	5P	7.874	2.047	-	4.016	1.305	0.979	1.125	4	5
M39 × 4	D9	TS039U9NEBA	1.5P	7.874	2.047	-	4.016	1.305	0.979	1.125	4	5
M39 × 3	D8	TS039S8NEB5	5P	7.874	2.047	-	4.016	1.305	0.979	1.125	4	5
M39 × 3	D8	TS039S8NEBA	1.5P	7.874	2.047	-	4.016	1.305	0.979	1.125	4	5
M39 × 2	D7	TS039Q7NEB5	5P	7.874	1.142	-	4.016	1.305	0.979	1.125	4	6
M39 × 2	D7	TS039Q7NEBA	1.5P	7.874	1.142	-	4.016	1.305	0.979	1.125	4	6
M39 × 1.5	D6	TS039O6NEB5	5P	7.874	1.142	-	4.016	1.305	0.979	1.125	4	6
M39 × 1.5	D6	TS039O6NEBA	1.5P	7.874	1.142	-	4.016	1.305	0.979	1.125	4	6
M39 × 1	D5	TS039M5NEB5	5P	7.874	1.142	-	4.016	1.305	0.979	1.125	4	6
M39 × 1	D5	TS039M5NEBA	1.5P	7.874	1.142	-	4.016	1.305	0.979	1.125	4	6
M42 × 4.5	D10	TS042VONEB5	5P	7.874	2.047	-	4.016	1.43	1.072	1.25	4	5
M42 × 4.5	D10	TS042VONEBA	1.5P	7.874	2.047	-	4.016	1.43	1.072	1.25	4	5

4

ANSI

Spiral Fluted Taps  
(for blind hole) ①

Spiral Fluted Taps  
(for through hole) ②

Spiral Pointed Taps  
(for through hole) ③

Hand Taps ④

Cemented Carbide Taps ⑤

Roll Taps ⑥

Special Thread Taps  
Simple Inspection Tools ⑦

Pipe Taps ⑧

Thread Mills  
Premium Thread Mills ⑨

Dies ⑩

Center Drills  
Centering Tools ⑪

Precision Machinery/  
Metal Surgical Instruments ⑫

ANSI

④-32

• This product is different from JIS products in shape and dimensions, please be careful when using.

# 4 Hand Tap Series

Overall length	Thread length	Thread + Neck length	Shank length	Shank dia.	Size of square	Length of square
L	ℓ	ℓn	ℓs	Ds	K	ℓk

- ① Spiral Fluted Taps (for blind hole)
- ② Spiral Fluted Taps (for through hole)
- ③ Spiral Pointed Taps (for through hole)
- ④ Hand Taps
- ⑤ Cemented Carbide Taps
- ⑥ Roll Taps
- ⑦ Special Thread Taps (Simple inspection tools)
- ⑧ Pipe Taps
- ⑨ Thread Mills (Premium Thread Mills)
- ⑩ Dies
- ⑪ Center Drills (Centering Tools)
- ⑫ Precision Machinery/ Medical Surgical Instruments

## HT Hand Taps

Size	Class	Code	Chamfer	L (inch)	ℓ (inch)	ℓn (inch)	ℓs (inch)	Ds (inch)	K (inch)	ℓk (inch)	No. of flutes	TYPE
M42 × 2	D7	TS042Q7NEB5	5P	7.874	1.142	-	4.016	1.43	1.072	1.25	4	6
M42 × 2	D7	TS042Q7NEBA	1.5P	7.874	1.142	-	4.016	1.43	1.072	1.25	4	6
M42 × 1.5	D6	TS042O6NEB5	5P	7.874	1.142	-	4.016	1.43	1.072	1.25	4	6
M42 × 1.5	D6	TS042O6NEBA	1.5P	7.874	1.142	-	4.016	1.43	1.072	1.25	4	6
M42 × 1	D5	TS042M5NEB5	5P	7.874	1.142	-	4.016	1.43	1.072	1.25	4	6
M42 × 1	D5	TS042M5NEBA	1.5P	7.874	1.142	-	4.016	1.43	1.072	1.25	4	6
M45 × 4.5	D10	TS045VONEB5	5P	8.661	2.323	-	4.409	1.519	1.139	1.25	4	5
M45 × 4.5	D10	TS045VONEBA	1.5P	8.661	2.323	-	4.409	1.519	1.139	1.25	4	5
M45 × 3	D8	TS045S8NEB5	5P	8.661	2.323	-	4.409	1.519	1.139	1.25	4	5
M45 × 3	D8	TS045S8NEBA	1.5P	8.661	2.323	-	4.409	1.519	1.139	1.25	4	5
M45 × 2	D7	TS045Q7NEB5	5P	8.661	1.22	-	4.409	1.519	1.139	1.25	4	6
M45 × 2	D7	TS045Q7NEBA	1.5P	8.661	1.22	-	4.409	1.519	1.139	1.25	4	6
M45 × 1.5	D6	TS045O6NEB5	5P	8.661	1.22	-	4.409	1.519	1.139	1.25	4	6
M45 × 1.5	D6	TS045O6NEBA	1.5P	8.661	1.22	-	4.409	1.519	1.139	1.25	4	6
M45 × 1	D5	TS045M5NEB5	5P	8.661	1.22	-	4.409	1.519	1.139	1.25	4	6
M45 × 1	D5	TS045M5NEBA	1.5P	8.661	1.22	-	4.409	1.519	1.139	1.25	4	6
M48 × 5	D11	TS048W-NEB5	5P	9.843	2.559	-	5.039	1.644	1.233	1.375	4	5
M48 × 5	D11	TS048W-NEBA	1.5P	9.843	2.559	-	5.039	1.644	1.233	1.375	4	5
M48 × 3	D9	TS048S9NEB5	5P	9.843	2.559	-	5.039	1.644	1.233	1.375	4	5
M48 × 3	D9	TS048S9NEBA	1.5P	9.843	2.559	-	5.039	1.644	1.233	1.375	4	5
M48 × 2	D7	TS048Q7NEB5	5P	9.843	1.22	-	5.039	1.644	1.233	1.375	4	6
M48 × 2	D7	TS048Q7NEBA	1.5P	9.843	1.22	-	5.039	1.644	1.233	1.375	4	6
M48 × 1.5	D7	TS048O7NEB5	5P	9.843	1.22	-	5.039	1.644	1.233	1.375	4	6
M48 × 1.5	D7	TS048O7NEBA	1.5P	9.843	1.22	-	5.039	1.644	1.233	1.375	4	6
M48 × 1	D6	TS048M6NEB5	5P	9.843	1.22	-	5.039	1.644	1.233	1.375	4	6
M48 × 1	D6	TS048M6NEBA	1.5P	9.843	1.22	-	5.039	1.644	1.233	1.375	4	6
For Unified Threads												
No.0-80UNF	GH1	TSUN0B1NEB5	5P	1.772	0.236	-	1.161	0.141	0.11	0.187	2	1
No.0-80UNF	GH1	TSUN0B1NEBA	1.5P	1.772	0.236	-	1.161	0.141	0.11	0.187	2	1
No.0-80UNF	GH2	TSUN0B2NEB5	5P	1.772	0.236	-	1.161	0.141	0.11	0.187	2	1
No.0-80UNF	GH2	TSUN0B2NEBA	1.5P	1.772	0.236	-	1.161	0.141	0.11	0.187	2	1
No.1-64UNC	GH1	TSUN1D1NEB5	5P	1.772	0.276	-	1.161	0.141	0.11	0.187	2	1
No.1-64UNC	GH1	TSUN1D1NEBA	1.5P	1.772	0.276	-	1.161	0.141	0.11	0.187	2	1
No.1-64UNC	GH2	TSUN1D2NEB5	5P	1.772	0.276	-	1.161	0.141	0.11	0.187	2	1
No.1-64UNC	GH2	TSUN1D2NEBA	1.5P	1.772	0.276	-	1.161	0.141	0.11	0.187	2	1
No.1-72UNF	GH1	TSUN1C1NEB5	5P	1.772	0.276	-	1.161	0.141	0.11	0.187	2	1
No.1-72UNF	GH1	TSUN1C1NEBA	1.5P	1.772	0.276	-	1.161	0.141	0.11	0.187	2	1
No.1-72UNF	GH2	TSUN1C2NEB5	5P	1.772	0.276	-	1.161	0.141	0.11	0.187	2	1
No.1-72UNF	GH2	TSUN1C2NEBA	1.5P	1.772	0.276	-	1.161	0.141	0.11	0.187	2	1
No.2-56UNC	GH1	TSUN2E1NEB5	5P	1.772	0.314	-	1.161	0.141	0.11	0.187	3	1
No.2-56UNC	GH1	TSUN2E1NEBA	1.5P	1.772	0.314	-	1.161	0.141	0.11	0.187	3	1
No.2-56UNC	GH2	TSUN2E2NEB5	5P	1.772	0.314	-	1.161	0.141	0.11	0.187	3	1
No.2-56UNC	GH2	TSUN2E2NEBA	1.5P	1.772	0.314	-	1.161	0.141	0.11	0.187	3	1
No.2-64UNF	GH1	TSUN2D1NEB5	5P	1.772	0.314	-	1.161	0.141	0.11	0.187	3	1
No.2-64UNF	GH1	TSUN2D1NEBA	1.5P	1.772	0.314	-	1.161	0.141	0.11	0.187	3	1
No.2-64UNF	GH2	TSUN2D2NEB5	5P	1.772	0.314	-	1.161	0.141	0.11	0.187	3	1
No.2-64UNF	GH2	TSUN2D2NEBA	1.5P	1.772	0.314	-	1.161	0.141	0.11	0.187	3	1
No.3-48UNC	GH1	TSUN3F1NEB5	5P	2.205	0.354	0.681	1.28	0.141	0.11	0.187	3	2
No.3-48UNC	GH1	TSUN3F1NEBA	1.5P	2.205	0.354	0.681	1.28	0.141	0.11	0.187	3	2









# 4 Hand Tap Series

Overall length	Thread length	Thread + Neck length	Shank length	Shank dia.	Size of square	Length of square
L	ℓ	ℓn	ℓs	Ds	K	ℓk

- ① Spiral Fluted Taps (for blind hole)
- ② Spiral Fluted Taps (for through hole)
- ③ Spiral Pointed Taps (for through hole)
- ④ Hand Taps
- ⑤ Cemented Carbide Taps
- ⑥ Roll Taps
- ⑦ Special Thread Taps (Simple inspection tools)
- ⑧ Pipe Taps
- ⑨ Thread Mills (Premium Thread Mills)
- ⑩ Dies
- ⑪ Center Drills (Centering Tools)
- ⑫ Precision Machinery/ Medical Surgical Instruments

## HT Hand Taps

Size	Class	Code	Chamfer	L (inch)	ℓ (inch)	ℓn (inch)	ℓs (inch)	Ds (inch)	K (inch)	ℓk (inch)	No. of flutes	TYPE
7/8-14UNF	GH6	TSU14Q6NEB5	5P	5.512	1.299	-	2.795	0.697	0.523	0.75	4	5
7/8-14UNF	GH6	TSU14Q6NEBA	1.5P	5.512	1.299	-	2.795	0.697	0.523	0.75	4	5
1-8UNC	GH4	TSU16X4NEB5	5P	6.299	1.457	-	3.228	0.8	0.6	0.812	4	5
1-8UNC	GH4	TSU16X4NEBA	1.5P	6.299	1.457	-	3.228	0.8	0.6	0.812	4	5
1-8UNC	GH5	TSU16X5NEB5	5P	6.299	1.457	-	3.228	0.8	0.6	0.812	4	5
1-8UNC	GH5	TSU16X5NEBA	1.5P	6.299	1.457	-	3.228	0.8	0.6	0.812	4	5
1-8UNC	GH6	TSU16X6NEB5	5P	6.299	1.457	-	3.228	0.8	0.6	0.812	4	5
1-8UNC	GH6	TSU16X6NEBA	1.5P	6.299	1.457	-	3.228	0.8	0.6	0.812	4	5
1-8UNC	GH7	TSU16X7NEB5	5P	6.299	1.457	-	3.228	0.8	0.6	0.812	4	5
1-8UNC	GH7	TSU16X7NEBA	1.5P	6.299	1.457	-	3.228	0.8	0.6	0.812	4	5
1-12UNF	GH4	TSU16S4NEB5	5P	6.299	1.457	-	3.228	0.8	0.6	0.812	4	5
1-12UNF	GH4	TSU16S4NEBA	1.5P	6.299	1.457	-	3.228	0.8	0.6	0.812	4	5
1-12UNF	GH5	TSU16S5NEB5	5P	6.299	1.457	-	3.228	0.8	0.6	0.812	4	5
1-12UNF	GH5	TSU16S5NEBA	1.5P	6.299	1.457	-	3.228	0.8	0.6	0.812	4	5
1-12UNF	GH6	TSU16S6NEB5	5P	6.299	1.457	-	3.228	0.8	0.6	0.812	4	5
1-12UNF	GH6	TSU16S6NEBA	1.5P	6.299	1.457	-	3.228	0.8	0.6	0.812	4	5
1 1/8-7UNC	GH6	TSU18Y6NEB5	5P	7.087	1.732	-	3.622	0.896	0.672	0.875	4	5
1 1/8-7UNC	GH6	TSU18Y6NEBA	1.5P	7.087	1.732	-	3.622	0.896	0.672	0.875	4	5
1 1/8-7UNC	GH7	TSU18Y7NEB5	5P	7.087	1.732	-	3.622	0.896	0.672	0.875	4	5
1 1/8-7UNC	GH7	TSU18Y7NEBA	1.5P	7.087	1.732	-	3.622	0.896	0.672	0.875	4	5
1 1/8-12UNF	GH5	TSU18S5NEB5	5P	7.087	1.732	-	3.622	0.896	0.672	0.875	4	5
1 1/8-12UNF	GH5	TSU18S5NEBA	1.5P	7.087	1.732	-	3.622	0.896	0.672	0.875	4	5
1 1/8-12UNF	GH6	TSU18S6NEB5	5P	7.087	1.732	-	3.622	0.896	0.672	0.875	4	5
1 1/8-12UNF	GH6	TSU18S6NEBA	1.5P	7.087	1.732	-	3.622	0.896	0.672	0.875	4	5
1 1/4-7UNC	GH6	TSU20Y6NEB5	5P	7.087	1.929	-	3.622	1.021	0.766	1	4	5
1 1/4-7UNC	GH6	TSU20Y6NEBA	1.5P	7.087	1.929	-	3.622	1.021	0.766	1	4	5
1 1/4-7UNC	GH8	TSU20Y8NEB5	5P	7.087	1.929	-	3.622	1.021	0.766	1	4	5
1 1/4-7UNC	GH8	TSU20Y8NEBA	1.5P	7.087	1.929	-	3.622	1.021	0.766	1	4	5
1 1/4-12UNF	GH5	TSU20S5NEB5	5P	7.087	1.929	-	3.622	1.021	0.766	1	6	5
1 1/4-12UNF	GH5	TSU20S5NEBA	1.5P	7.087	1.929	-	3.622	1.021	0.766	1	6	5
1 1/4-12UNF	GH6	TSU20S6NEB5	5P	7.087	1.929	-	3.622	1.021	0.766	1	6	5
1 1/4-12UNF	GH6	TSU20S6NEBA	1.5P	7.087	1.929	-	3.622	1.021	0.766	1	6	5
1 3/8-6UNC	GH6	TSU22Z6NEB5	5P	7.874	2.165	-	4.016	1.108	0.831	1.062	4	5
1 3/8-6UNC	GH6	TSU22Z6NEBA	1.5P	7.874	2.165	-	4.016	1.108	0.831	1.062	4	5
1 3/8-6UNC	GH8	TSU22Z8NEB5	5P	7.874	2.165	-	4.016	1.108	0.831	1.062	4	5
1 3/8-6UNC	GH8	TSU22Z8NEBA	1.5P	7.874	2.165	-	4.016	1.108	0.831	1.062	4	5
1 3/8-12UNF	GH5	TSU22S5NEB5	5P	7.874	2.165	-	4.016	1.108	0.831	1.062	6	5
1 3/8-12UNF	GH5	TSU22S5NEBA	1.5P	7.874	2.165	-	4.016	1.108	0.831	1.062	6	5
1 3/8-12UNF	GH6	TSU22S6NEB5	5P	7.874	2.165	-	4.016	1.108	0.831	1.062	6	5
1 3/8-12UNF	GH6	TSU22S6NEBA	1.5P	7.874	2.165	-	4.016	1.108	0.831	1.062	6	5
1 1/2-6UNC	GH6	TSU24Z6NEB5	5P	7.874	2.323	-	4.016	1.233	0.925	1.125	4	5
1 1/2-6UNC	GH6	TSU24Z6NEBA	1.5P	7.874	2.323	-	4.016	1.233	0.925	1.125	4	5
1 1/2-6UNC	GH8	TSU24Z8NEB5	5P	7.874	2.323	-	4.016	1.233	0.925	1.125	4	5
1 1/2-6UNC	GH8	TSU24Z8NEBA	1.5P	7.874	2.323	-	4.016	1.233	0.925	1.125	4	5
1 1/2-12UNF	GH5	TSU24S5NEB5	5P	7.874	2.323	-	4.016	1.233	0.925	1.125	6	5
1 1/2-12UNF	GH5	TSU24S5NEBA	1.5P	7.874	2.323	-	4.016	1.233	0.925	1.125	6	5
1 1/2-12UNF	GH7	TSU24S7NEB5	5P	7.874	2.323	-	4.016	1.233	0.925	1.125	6	5
1 1/2-12UNF	GH7	TSU24S7NEBA	1.5P	7.874	2.323	-	4.016	1.233	0.925	1.125	6	5