

| Shank dia. | Holder dia. | Recess dia. | Overall length | Shank length | Depth of die mounting | Cutting depth | Outside dia of Die | Thickness of Die |
|------------|----------------|----------------|----------------|----------------|-----------------------|----------------|--------------------|------------------|
| Ds | D ₁ | D ₂ | L | ℓ _s | ℓ | ℓ ₁ | D | T |

ANSI

ANSI

RD-DA

Die Attachment (Designed Specially for Solid Round Dies)



Specification



- Tooling designed specially for solid dies, with the mechanism to compensate for feed error and to absorb misalignment.
- Combined with CNC toolings, this attachment enables the cutting of external threads on complex workpieces with ease.

TYPE:1

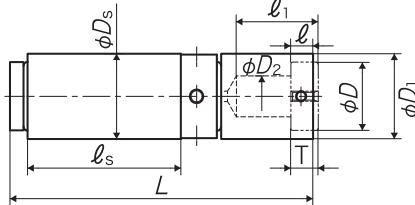

TYPE:2

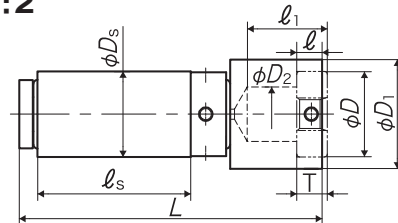

Segment : 3A

| Code | Ds (inch) | D ₁ (inch) | D ₂ (inch) | L (inch) | ℓ _s (inch) | ℓ (inch) | ℓ ₁ (inch) | D (inch) | T (inch) | TYPE |
|-----------|--------------|--------------------------|--------------------------|-------------|--------------------------|-------------|--------------------------|-------------|-------------|------|
| DA10-0.75 | 0.75 | 0.787 | 0.236 | 2.795 | 1.574 | 0.118 | 0.433 | 0.394 | 0.137 | 1 ▲ |
| DA16-0.75 | 0.75 | 0.787 | 0.393 | 2.992 | 1.574 | 0.177 | 0.63 | 0.63 | 0.196 | 1 ▲ |
| DA20-1 | 1 | 0.984 | 0.472 | 3.503 | 1.771 | 0.255 | 0.885 | 0.787 | 0.275 | 1 ▲ |
| DA25-1 | 1 | 1.26 | 0.63 | 3.503 | 1.771 | 0.295 | 0.866 | 0.984 | 0.354 | 2 ▲ |
| DA38-1.25 | 1.25 | 1.968 | 1.023 | 4.803 | 2.362 | 0.433 | 1.417 | 1.496 | 0.511 | 2 ▲ |

Note: Products marked with an ▲ in the stock column are available while supplies last.

1

Spiral Fluted Taps
(for blind hole)

2

Spiral Fluted Taps
(for through hole)

3

Spiral Pointed Taps
(for through hole)

4

Hand Taps

5

Cemented
Carbide Taps

6

Roll Taps

7

Special Thread Taps
Simple Inspection Tools

8

Pipe Taps

9

Thread Mills
Premium Thread Mills

10

Dies

11

Center Drills
Centering Tools

12

Precision Machinery/
Medical Surgical Instruments

ANSI