

Overall length	Pin length	Bored hole dia. Thread engagement 90%	Bored hole dia. Thread engagement 75%	Bored hole dia. Thread engagement 60%	d <sub>1</sub> length	d <sub>2</sub> length	d <sub>3</sub> length	Shank dia.
L	ℓ	d <sub>1</sub>	d <sub>2</sub>	d <sub>3</sub>	ℓ <sub>1</sub>	ℓ <sub>2</sub>	ℓ <sub>3</sub>	D <sub>s</sub>

- ① Spiral Fluted Taps (for blind hole)
- ② Spiral Fluted Taps (for through hole)
- ③ Spiral Pointed Taps (for through hole)
- ④ Hand Taps
- ⑤ Cemented Carbide Taps
- ⑥ Roll Taps
- ⑦ Special Thread Taps Simple Inspection Tools
- ⑧ Pipe Taps
- ⑨ Thread Mills Premium Thread Mills
- ⑩ Dies
- ⑪ Center Drills Centering Tools
- ⑫ Precision Machinery/Medical Surgical Instruments



## CPR-Y

Check-Pins for Bored Holes in Thread Form Tapping for R-Y Taps.



### Specification

**HSS**

■ Check pin for R-Y is the pin to check the bored hole dia. for R-Y forming taps.

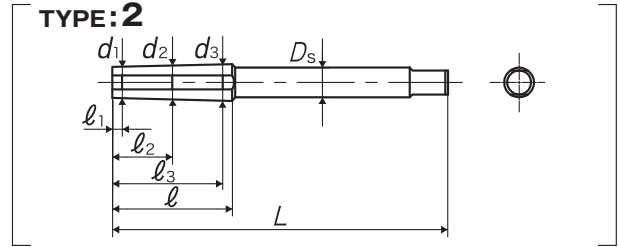
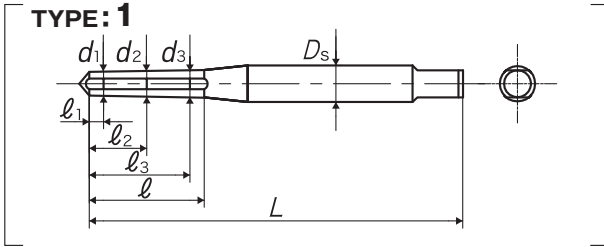

Segment : 1J

Size	Code	L (mm)	ℓ (mm)	d <sub>1</sub> Thread engagement ratio 90%	d <sub>2</sub> Thread engagement ratio 75%	d <sub>3</sub> Thread engagement ratio 60%	ℓ <sub>1</sub> (mm)	ℓ <sub>2</sub> (mm)	ℓ <sub>3</sub> (mm)	D <sub>s</sub> (mm)	TYPE	MSRP
For Metric Threads												
M2	CPRY2.0E	42	9	1.83	1.86	1.89	1.5	4.5	7.5	3	1	¥ 1,120 □
M2.5	CPRY2.5F	44	10	2.31	2.34	2.37	2	5	8	3	1	¥ 800 □
M2.6	CPRY2.6F	44	10	2.41	2.44	2.47	2	5	8	3	1	¥ 750 □
M3	CPRY3.0G	46	13	2.78	2.83	2.87	2	6.5	11	4	1	¥ 710 □
M4	CPRY4.0I	52	16	3.69	3.75	3.81	2	8	14	5	1	¥ 670 □
M5	CPRY5.0K	60	16	4.65	4.71	4.77	2	8	14	5.5	1	¥ 700 □
M6	CPRY6.0M	62	19	5.55	5.63	5.70	2	9.5	17	6	1	¥ 740 □
M8	CPRY8.0N	70	25	7.42	7.53	7.63	2	12.5	23	6.2	2	¥ 1,100 □

※Please use CPR-Y for controlling bored holes for R-Y taps.